



CROWNE PLAZA
BERLIN - POTSDAMER PLATZ



**EVERYTHING
AT A GLANCE.**

Collect valuable
**IHG® Business Rewards
Club points** now!
Learn more inside.

KNOWING WHAT IT'S ALL ABOUT

Where love letters and postcards were once sent out into the world, the Post Palais now marks the site of the Crowne Plaza® Berlin-Potsdamer Platz, combining modern design with historic architecture. Situated right in Berlin's city centre, near the Brandenburg Gate and Checkpoint Charlie, offers a wide range of services, addressing the needs of its guests by following Crowne Plaza's "You First" motto.

The success of your event is based on meticulous planning by an experienced, creative team which leaves nothing to chance. As such, our Crowne Plaza Meetings Director will personally oversee your meeting, as your one point of contact. With over 500 sqm, our meetings and events space offers 8 flexible function rooms with numerous lay out options and state-of-the-art technology. If you are looking for an inspiring interactive environment, our themed event spaces Theodor Fontane and Albert Einstein provide the right setting for you.

AT A GLANCE

- 256 hotel rooms (including 19 suites)
- 8 conference rooms over a total area of 500 sqm
- State-of-the-art conference technology
- 2 themed rooms for inspiring meetings
- Free WiFi
- Concierge service and business centre
- Jogging station with fruit and water



IHG® BUSINESS REWARDS – WORTH YOUR WHILE

Whether you're organising a meeting or holding a family party, we want to reward you for your booking. With IHG® Business Rewards, you earn points for every guest room booked, and every event held at our hotel.

- ✓ Earn 3 points for every US Dollar spent
- ✓ No minimum amount and up to 60,000 points
- ✓ Attractive rewards, such as gift vouchers, flights and free stays. Or donate your points to charity.
- ✓ Exclusive offers for members

Contact us!

MAKE YOURSELF COMFORTABLE

The Post Brasserie

A historic backdrop, a relaxed atmosphere with Art Deco features, and culinary delights served from the 360° show kitchen.

Seating capacity: 124

The Post Bar

At this popular meeting place for Berlin locals and hotel guests, only the finest spirits are used in cocktails and long drinks. Enjoy also our exclusive signature drinks.

Seating capacity: 45

Gym and wellness facility | complimentary

Whether steam bath, Finnish dry sauna or modern cardio equipment – this is where you can revitalise your mind, body and spirit.

Sleep Advantage® programme | complimentary

Extra comfy, top-quality beds, an aromatherapy set and a personal wake-up call guarantee you a restful sleep.



BRASSERIE & BAR

THE POST

Part of the history



THE POST BRASSERIE

Good conversation and a casual atmosphere fill the room, while treats from the 360° show kitchen are being served. The Post Brasserie is the perfect place for lunch or dinner over the course of your event.

Our attentive service and culinary creations, prepared with great care and attention to detail, cater for up to 124 people.

We create set menus and buffets tailored to your specific needs, contributing our experience and innovative ideas to assist with your plans.

Simply contact us for more information.

THE POST BAR

See out the day at The Post Bar. Situated in the heart of one of Berlin's hippest areas, it's a popular meeting place for Berlin locals and hotel guests alike.

If you require privacy, why don't you book our bar for an exclusive reception to kick off or close your function or to host a networking event in a relaxed atmosphere.



Room	Reception	Theatre	Parliament	Banquet	Board Room	U shape	Size (sqm)	Length x Width (m)	Ceiling height (m)	Door height (m)
Post Palais 1–3	250	220	120	140 120 w/o w stage	64	65	265	10.5 x 26.1	2.5	2.13
Post Palais 1+2	180	130	90	60	44	35	189	10.5 x 18.6	2.5	2.13
Post Palais 2+3	160	120	80	80	24	32	166	10.5 x 16	2.5	2.13
Post Palais 1	90	40	24	40	14	24	104	10.5 x 12	2.5	2.13
Post Palais 2	90	35	24	30	16	22	90	10.5 x 8.5	2.5	2.13
Post Palais 3	70	30	26	30	16	16	75	10.5 x 7.3	2.5	2.13
Post Palais Foyer	150	—	—	—	—	—	85	Ø 10.5	3	—
Board Room	8	8	4	—	6	6	15	4.8 x 3.6	2.5	2.13
Hildegard Knef	40	32	20	30	18	18	56	10.1 x 5.7	3.3	2.13
Marlene Dietrich	40	32	20	30	18	18	56	10.1 x 5.7	3.3	2.13
Hildegard Knef + Marlene Dietrich	110	64	40	60	22	22	114	10.1 x 11.6	3.3	2.13
Conferencesuite	—	6	—	—	—	—	16	3.75 x 5.9	3.7	2.13
Theodor Fontane	40	40	16	30	18	18	60	9.6 x 5.9	3.3	2.13
Albert Einstein	60	30	12	20	14	15	75	10.4 x 7.3	3.3	2.13

Theodor Fontane

With plenty of natural light and overlooking our green area, appointed in the style of an 18th-century library, the shelves in this room are lined with historic French literature.



Albert Einstein

Whether it be cork, a blackboard or a white board, every wall here has a special feature. The one-way mirror partition is another highlight, whilst the in-built ENO board for interactive presentations adds technical flair.





GROUND FLOOR

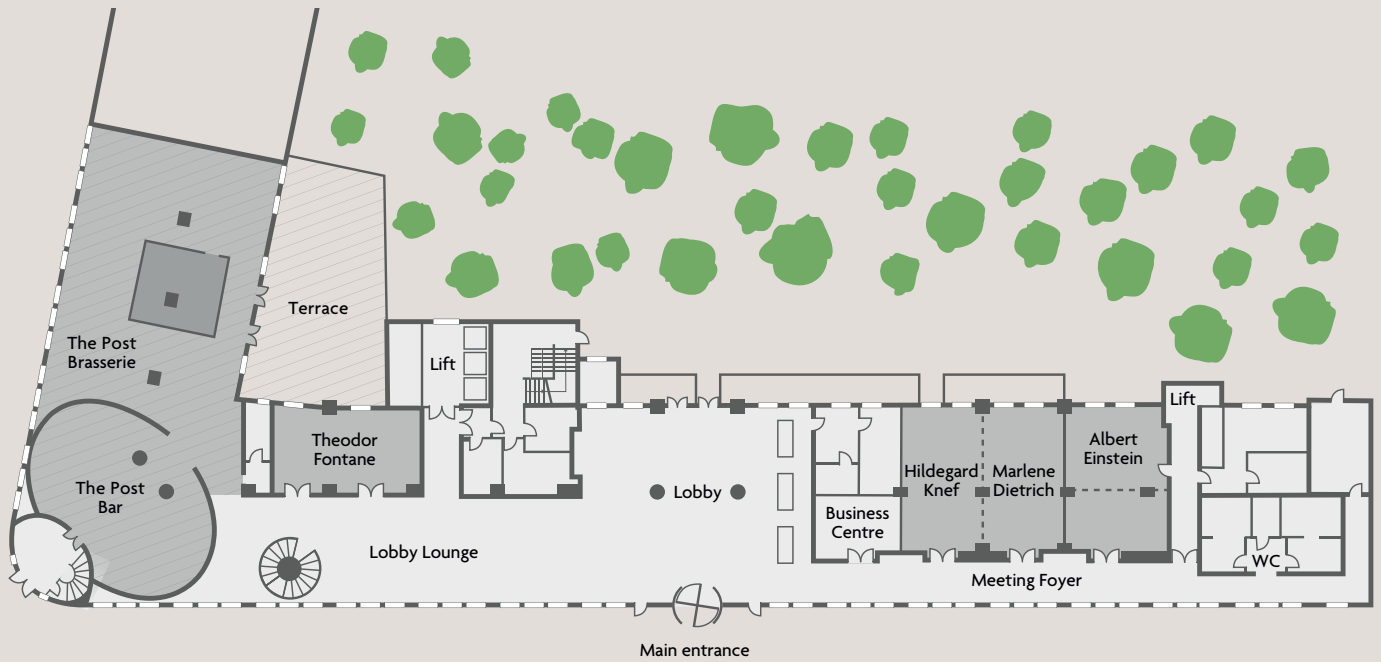

BASEMENT



IN THE HEART OF THE CITY

Our 4-star superior hotel is located in the heart of Berlin, just near Potsdamer Platz. Bus stops, S & U Bahn stations are all within a few minutes' walk.



Berlin-Tegel (TXL)

25 minutes by car/taxi (12 km)

40 minutes by public transport
(TXL bus line to Brandenburg Gate, then continue on S-Bahn line 2 to Anhalter Bahnhof)

Berlin-Schönefeld (SXF)

35 minutes by car/taxi (20 km)

50 minutes by public transport
(bus line X7 or 171 to Rudow, then continue on U-Bahn line 7 to Möckernbrücke)



Berlin Hauptbahnhof train station

10 minutes by car/taxi (4 km)

15 minutes by public transport
(bus M41 to Willy-Brandt-Haus or U-Bahn line 55 to Brandenburg Gate, then continue on S-Bahn line 2 to Anhalter Bahnhof)



Highway A100

Tempelhofer Damm exit, then continue on B96 (6 km)



CROWNE PLAZA® BERLIN - POTSDAMER PLATZ

Hallesche Straße 10, 10963 Berlin, Deutschland

Tel: +49 (0)30 801 066 614

Fax: +49 (0)30 801 066 666

E-Mail: events.cpberlin@ihg.com

Besitzer dieses Hotels ist die Möckernstraße Hotelbetriebsgesellschaft mbH.
Das Hotel wird betrieben von der InterContinental Hotels Management GmbH.

This hotel is owned by Möckernstraße Hotelbetriebsgesellschaft mbH
and operated by InterContinental Hotels Management GmbH.