



# *PULLMAN BERLIN SCHWEIZERHOF*





## ***PULLMAN BERLIN SCHWEIZERHOF***

**The hotel, which enjoys a central location in Berlin, has a reputation for excellent event management since many years. Located very close to the Kaiser Wilhelm Memorial Church and famous Kurfürstendamm, the Pullman hotel represents a flexible location much in demand for professional events.**

### ***THE PLACE TO BE IN THE CAPITAL CITY***

If you're looking for an excellently situated venue in the best location, the Pullman Berlin Schweizerhof by the Zoologischer Garten you will want to keep in mind. The exhibition centre, airports, companies, embassies and numerous sights can be reached quickly on foot or within a short journey.

### ***AN AMBIENCE OF HARMONY***

The Bauhaus-style hotel unites an avant-garde interior with simple functionality. Visually, the boundaries to the outside, which were designed by the Sundukovy Sisters and inspired by the Zoological Gardens opposite, are blurred.

### ***HOTEL CHARACTERISTICS***



Optimal event conditions: 18 flexible conference rooms over 1,610 sq. m.

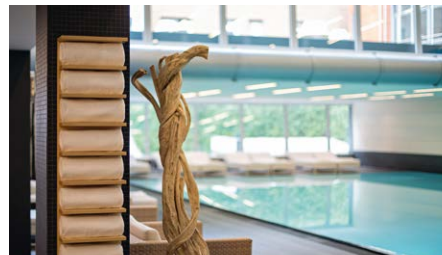

Fit and Spa Lounge: modern atmosphere with indoor pool.



BLEND is exactly what it says: a mix of aromas, scents and the culinary styles of Berlin.

## ROOMS: STYLISHLY DESIGNED COMFORT

- 285 Superior rooms, some with view of the Zoo and Tiergarten
- 68 Deluxe rooms
- 10 Junior suites in a peaceful location
- 10 Deluxe suites
- 4 disabled access rooms

Facilities:

- Free Internet access
- C.O. Bigelow toiletries
- Nespresso coffee machines in Deluxe rooms and suites
- Spacious work area



1.

## CREATIVE GASTRONOMY AND BEVERAGES FOR DAY AND NIGHT

- The BLEND berlin kitchen and bar is inspired by the multicultural character of Berlin. The various dishes reflect the melting pot that is Berlin with its multifaceted and international dining culture.
- From 6.30 a.m. the BLEND team spoils guests in the bar with coffee and a small breakfast selection as well as drinks and hot and cold snacks – the ideal place to enjoy a good chat and relax together.
- Our extensive breakfast buffet is served every morning in Le Bouveret.
- 24-hour room service is also offered.



2.

## MODERN FIT AND SPA LOUNGE

The stylish Fit and Spa Lounge has an indoor pool and sauna, as well as a relaxation area with hydrotherapy showers, ice fountains and heated bench. It is open daily from 6:30am – 10pm. There is also an 85 sq. m fitness room open around the clock with cutting-edge Technogym and Kinesis equipment.



3.

## CONNECTIVITY BY PULLMAN

- Free Wi-Fi across the hotel
- Connectivity Lounge by Pullman with high-tech equipment by Apple
- Glass-fibre technology

1. SUPERIOR ROOM 2. BREAKFAST RESTAURANT «LE BOUVERET» 3. BALLROOM



# comeeting

## PROFESSIONAL SERVICE, THE HIGHEST LEVEL OF QUALITY AND THE BEST EQUIPMENT FOR SUCCESSFUL EVENTS

Lots of space for your wishes and ideas and lots of room for your event for up to 950 people. Pullman stands for an inspiring hotel concept for discerning cosmopolitan people who expect more from premium hotels – as well as for the conference concept Co-Meeting by Pullman that focuses on the individual needs of event planners – with flexible event areas, cutting-edge technology and creative gastronomy:

- A tailored offer within 24 hours helps you to make a quick, well-founded decision.
- Individual management of your event ensures that your congress or conference will run seamlessly and successfully: a Pullman Event Manager will be at your side from start to finish.

- Innovative Breaks: creative fringe programmes such as team-building measures, trips or yoga sessions will give your event space for fresh ideas and a unique character.
- Varied, regionally-inspired gastronomy: the culinary offer can be tailored to suit every occasion and taste. Exquisite wines from the Vinoteca by Pullman selection complete your menu choices.

**THE PULLMAN BERLIN SCHWEIZERHOF OFFERS 1,610 sq. m OF EVENT SPACE SPREAD ACROSS TWO FLOORS. A TOTAL OF UP TO 950 PEOPLE CAN BE WELCOMED IN THE 18 CONFERENCE ROOMS, ALL OF WHICH HAVE NATURAL DAYLIGHT.**

ROOM NAME	SIZE (sq. m.)	CEILING HEIGHT (m)	BOARD ROOM	U-SHAPE	PARLIAMENT-STYLE	THEATRE	RECEPTION	BANQUET	CABARET
Basel	216	3,80	46	45	117	190	180	120	72
Basel/Bern/Genf/Zürich	686	3,80	0	90	408	458	450	400	276
Basel/Genf	340	3,80	70	69	198	288	250	180	144
Basel/Zürich	436	3,80	70	75	198	300	250	240	156
Bern	124	3,80	34	30	66	102	70	60	36
Bern/Zürich	342	3,80	70	69	198	288	250	180	156
Genf	123	3,80	34	30	66	102	70	60	36
Zürich	217	3,80	46	45	108	180	180	120	72

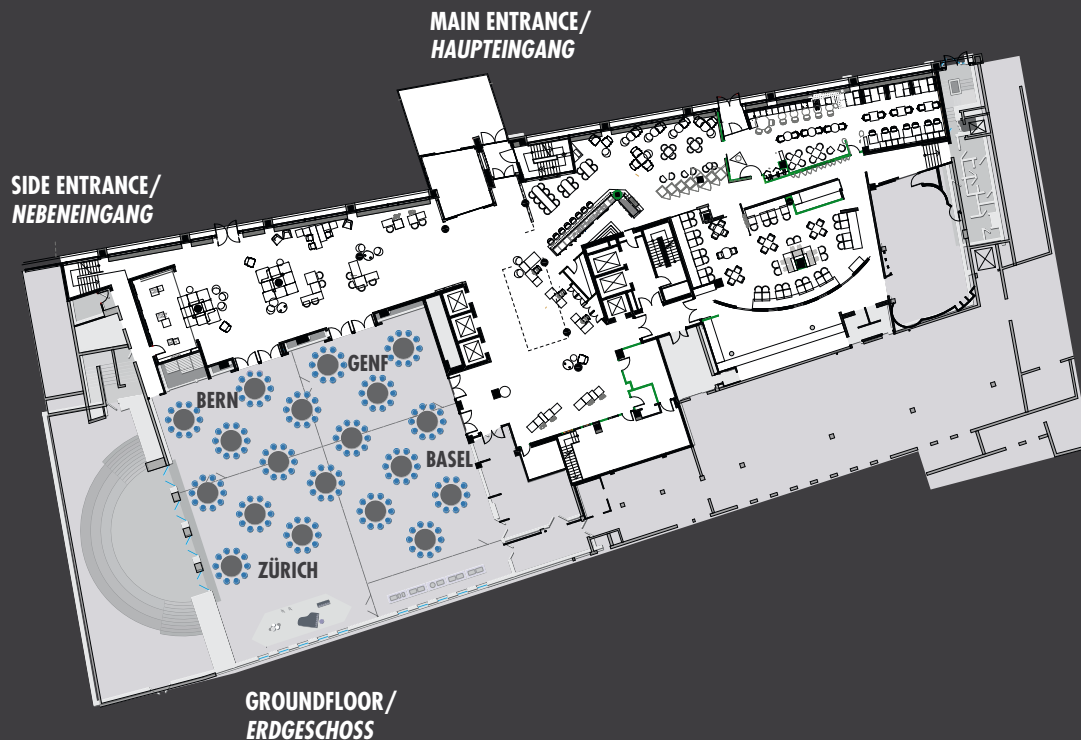



ROOM NAME	SIZE (sq. m.)	CEILING HEIGHT (m)	BOARD ROOM	U-SHAPE	PARLIAMENT-STYLE	THEATRE	RECEPTION	BANQUET	CABARET
Arosa 1	33	3,00	16	0	15	20	20	16	0
Arosa 1/2	104	3,00	0	0	0	0	70	60	0
Arosa 1/2/3	170	3,00	0	0	0	0	150	130	0
Arosa 2	71	3,00	28	0	33	40	50	40	30
Arosa 2/3	137	3,00	0	0	0	0	120	90	0
Arosa 3	66	3,00	22	24	30	40	50	40	24
Chur 1	41	3,00	22	15	18	30	30	24	18
Chur 1/2	82	3,00	46	34	45	60	60	48	42
Chur 1/2/3	123	3,00	70	58	78	100	90	72	66
Chur 2	41	3,00	22	15	18	30	30	24	18
Chur 2/3	82	3,00	46	34	45	60	60	48	42
Chur 3	41	3,00	22	15	18	30	30	24	18
Davos 1	82	3,00	28	25	45	68	70	60	40
Davos 1/2	165	3,00	40	40	90	155	120	100	80
Davos 2	75	3,00	28	25	45	70	70	50	40
Lausanne	65	3,00	28	24	30	40	40	30	24
St. Moritz	55	3,00	12	0	0	0	0	0	0
Tessin 1	92	3,00	34	30	54	80	70	60	36
Tessin 1/2	187	3,00	40	45	105	176	180	150	72
Tessin 1/2/3	280	3,00	64	63	165	255	250	210	108
Tessin 2	92	3,00	34	30	54	80	70	60	36
Tessin 2/3	187	3,00	40	45	105	176	180	150	72
Tessin 3	92	3,00	34	30	54	80	70	60	36
Winterthur	60	3,00	28	24	30	40	40	30	24

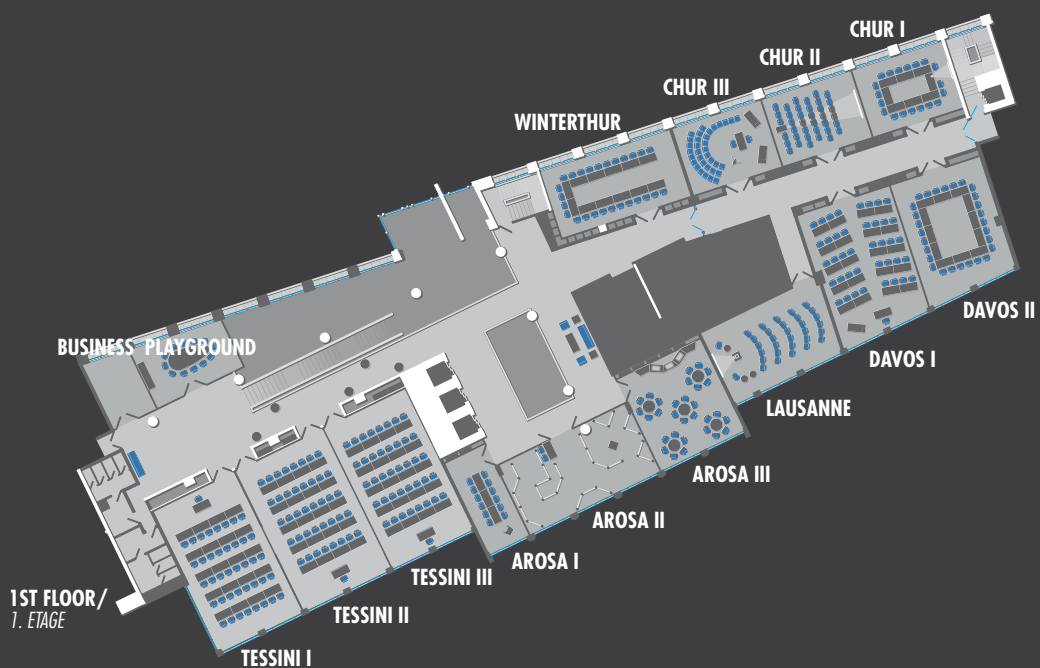

1.



2.



3.



4.



1. BUSINESS PLAYGROUND BY PULLMAN - 2. „ONEX“ FOR LUNCH- & DINNEREVENTS - 3. RESTAURANT BLEND BERLIN KITCHEN AND BAR - 4. COFFEE BREAKS IN THE GARDEN COURTYARD

## **EXCELLENT EVENT MANAGEMENT: AN EXPERIENCED TEAM STANDS FOR QUALITY**

Many international events have been successfully implemented at the Pullman Berlin Schweizerhof over the years. Experience meets the optimal on-site conditions here: the 18 flexible air-conditioned conference rooms with natural daylight are spread out across a spacious 1,610 sq. m. Cutting-edge conference and presentation technology is a matter of course.

The reason that the VDR-certified business, conference and green hotel enjoys an excellent reputation as a venue is primarily due to the long-standing experience of the Event Managers. They always take a careful, solution-oriented approach to ensure that every event has exactly the framework that is needed. The hotel's catering service for external events of up to 500 people is also a service very much valued in the capital city.

## SPECIAL EXTRAS FOR MEETING PLANNERS

With the meeting planner offer, the free Le Club Accorhotels loyalty scheme offers tailored benefits for event organisers.

They can collect valuable loyalty points for bonus-eligible events and enjoy benefits across the world in Sofitel, Pullman, MGallery, Novotel, Suite Novotel, Mercure and ibis Styles hotels.

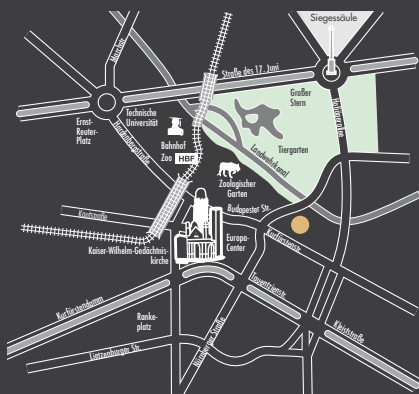

**PULLMAN BERLIN SCHWEIZERHOF**  
Budapester Strasse 25, 10787 Berlin, Germany  
T. +49 30 2696 0 F. +49 30 2696 1000 E. H5347@accor.com

### DIRECTIONS FROM AIRPORT:

- From Berlin Tegel, take the bus X9 to Zoologischer Garten – approx. 20 minutes by taxi
- From Berlin Schönefeld, take S-Bahn overground line 9 to Zoologischer Garten – approx. 40 minutes by taxi

### DIRECTIONS FROM MAIN STATION:

- Approx. 10 – 15 minutes by taxi
- S-Bahn overground line to Zoologischer Garten

### DIRECTIONS BY PUBLIC TRANSPORT:

- To station Zoologischer Garten with U2, U9, S5, S7, S9 or with bus X9
- To station Budapester Strasse with bus 200

[pullmanhotels.com/5347](http://pullmanhotels.com/5347)  
[pullman-berlin-schweizerhof.com](http://pullman-berlin-schweizerhof.com)