

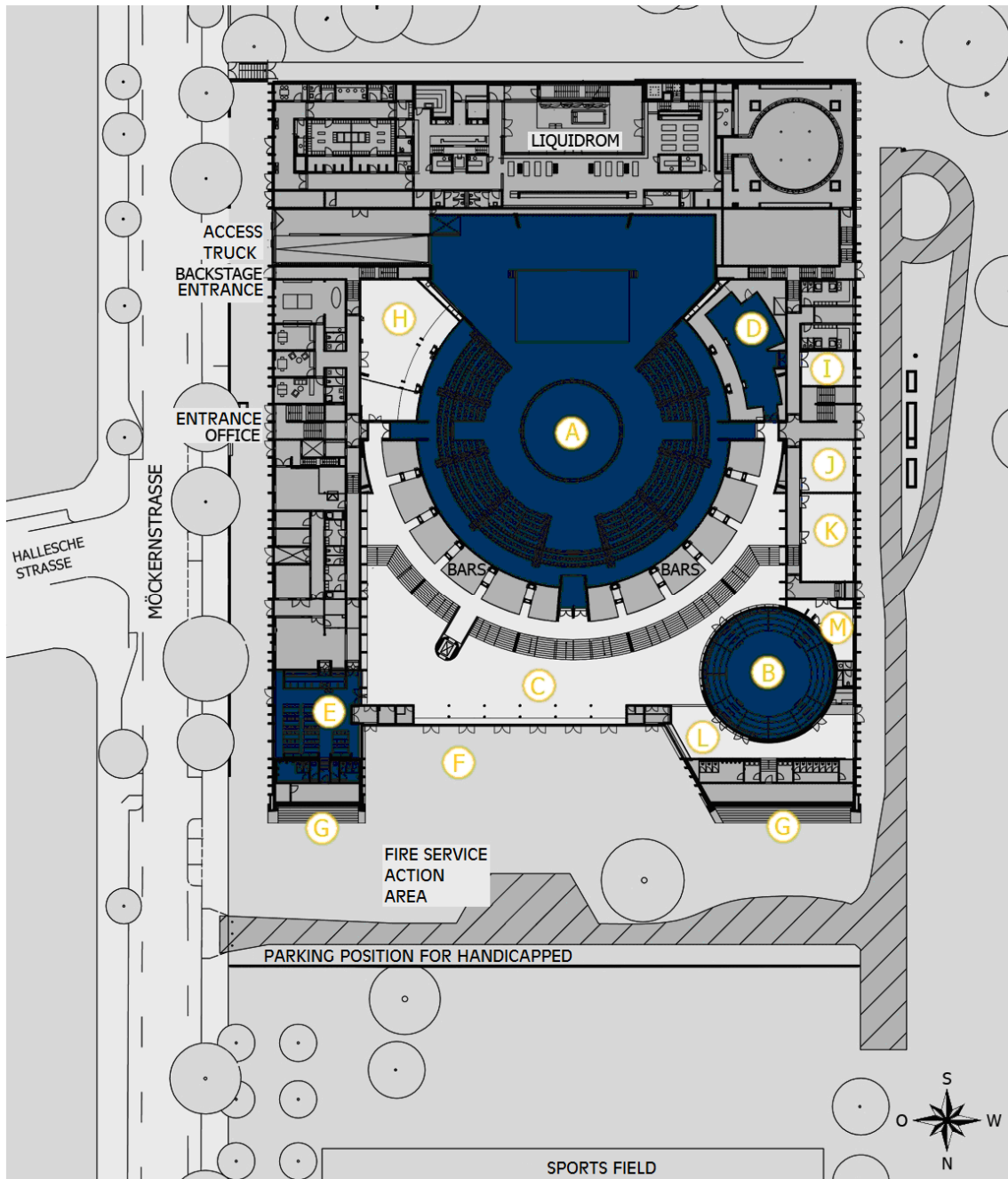

CONTENTS

LAYOUT		3
AREAS – DESCRIPTION AND TECHNICAL INFORMATION		
A	Big Arena	4
	Description	
	Technical equipment	5
	Rigging points	6
	Seating options	
	Option A1 – Full seating	7
	Option A2 – Standing room only	7
	Option A3 & A4 – Gala dinner	8
	Option A5 & A6 – Conference	9
	Option A7 – Reception	10
	Option A8 – Sport with special stands	10
	Option A9 – Boxing, wrestling	11
	Option A10 – Circus seating	11
	Block overview full seating/ standing room options	12
B	Small Arena	13
	Description	
	Technical equipment/ Rigging points	14
	Seating options	
	Option B1 – Full seating	15
	Option B2 – Standing room	15
C	Foyer	16
	Description/ Technical equipment	
D	Lounge	17
	Description/ Technical equipment	
E	Forecourt / outdoor area	18
	Description/ Technical equipment	
F	Roof terrace	19
	Description/ Technical equipment	
G	Backstage East	20
	Description/ Technical equipment	
H	Backstage West – Dressing Room 1	21
	Description/ Technical equipment	
I	Backstage West - Catering, Dressing Room 2	22
	Description/ Technical equipment	
SERVICE PARTNERS		23
	Catering Sarah Wiener / TSE AG / B.E.S.T. Veranstaltungsdienste GmbH	
	Brandschutzbüro und Dienstleistungen Behring GmbH / GRG Services Berlin	
INFORMATION FOR EVENT ORGANISERS		24
INFRASTRUCTURE		26
TRANSPORT ACCESS		27
CONTACT		28
LAYOUT AND OVERVIEWS		29



- | | | | |
|---|--------------|---|-----------------------|
| A | BIG ARENA | H | BACKSTAGE EAST |
| B | SMALL ARENA | I | DRESSING ROOM 1 |
| C | FOYER | J | DRESSING ROOM 2 |
| D | LOUNGE | K | CATERING |
| E | RESTAURANT | L | FOYER SMALL ARENA |
| F | FORECOURT | M | BACKSTAGE SMALL ARENA |
| G | ROOF TERRACE | | |

The Liquidrom does not belong to Tempodrom premises.

A BIG ARENA

DESCRIPTION

The focus of the Tempodrom is the Big Arena. This can be entered from both ground and basement levels and is connected to the outdoor area via the roof terrace.

The circus ring with a diameter of 25 m can be enlarged through retraction of the stands by 8.5 m to 33.5 m.

Due to its adjustable size, the Big Arena is the ideal venue for a variety of events. The spectacular roof construction of the Big Arena rises from the upper circles to a height of 30 m.

The backstage area of the Big Arena is accessed via a ramp. Access for lorries (max. 40t) is possible upon clearing the parking zone in front of the delivery bay.

Backstage East on the basement floor consists of three dressing rooms, showers, WCs, VIP dressing room, two production offices and a tea kitchen. On the opposite side are the electrical operating rooms with sub-distribution for the stage.

Backstage West is located on the ground floor on the west side. This consists of an artist dressing room, a generously sized production office, a large fully equipped kitchen with adjoining crew catering room and a separate sanitary facility including showers.

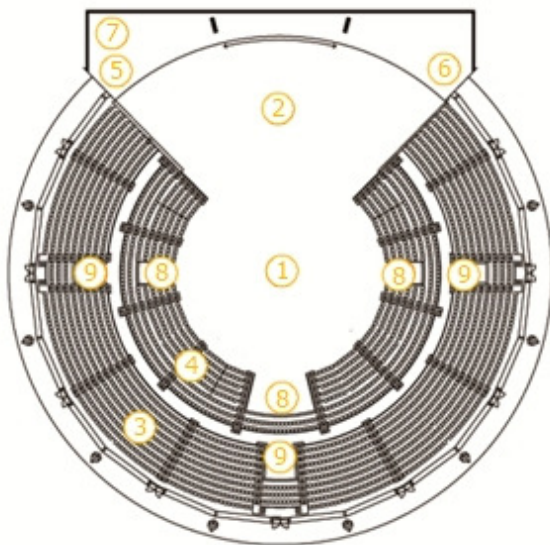

WALLS

The Big Arena entrance area walls are of exposed concrete.

The backstage area behind the Scene area can be divided as required by a black curtain. The glass façade running behind the upper circle can be darkened through automatically powered curtains.

CEILINGS

The ceiling suspended below the roof is constructed of sound absorbing light timber boards. A steel-glass construction is the foundation of the skylights at the centre of the roof, which are equipped with a blind system.

FLOOR

The floor of the Big Arena consists of anthracite coloured mastic asphalt (SLW30-suitable). In addition there are also diverse floor anchoring points.

EQUIPMENT

The individual seats are manufactured of dark grey veneered wood.

The lower circle is constructed as a mobile stand. Through the retraction of this mobile stand, the arena can be enlarged by a diameter of approx. 8.5m.

Traverses for lighting and acoustic elements or similar can be installed using the rigging points distributed across the entire roof.

At the centre of the approx. 30 m high room is a ring-formed, height-adjustable traverse for the installation of event technology with the corresponding junction boxes.

The capacity of your event may deviate from the options provided here. The specific capacity can be determined in cooperation with the Tempodrom Technical Management.

- 1 circus ring
- 2 Scene rear area
- 3 upper circle
- 4 lower circle
- 5 entry backstage
- 6 operating room access
- 7 access loading ramp
- 8 access lower circle
- 9 access upper circle

TECHNICAL EQUIPMENT

4	mobile stands (lower circle, rows 1-6) under the mobile stands: - 2 x double schuko - 2 x 16 A CEE 5-pol 6h	
88	rigging points in the roof construction: load capacity per 1 t (linear order) load capacity per 2.5 t (ring-formed order) load capacity per 5 t (for ring)	
	Additional use of anchor points in circus ring floor and entrances to the Big Arena is possible upon consultation with the Technical Management.	
1	1 Eurotruss system ring traverse, anchored under the crown of the roof: Eurotruss ST External diameter Chain hoists BGV C1 load capacity: load capacity Ring: highest position lowest position Connections: - 120 x 2 kW (18 x HAN 16) - 9 x 32 A CEE 3-pol (4 x Han 6) Feed- in power operating room - 3 x 16 A CEE 5-pol 6h - 2 x 32 A CEE 5-pol 6h - 4 x lines DMX - 2 x video cable	50 x 50 cm 14,40 m 6 pcs. per 1,3t 108 kg/m +20,00 m +1,0 m 4 x XLR RGB-AV
1	PreRigg Front truss folding truss 16,25 m load capacity: on 2 x 1,0 t BGV C1-Motor load capacity: Back truss folding truss 29,25 m on 3 x 1,0 t BGV C1-Motor load capacity: 2 x PA-Truss folding truss 6,5m load capacity:	100Kg/m per 1 t per 1 t max. 1,3 t distributed load

POWER CONNECTIONS

Scene area distributed between six junction boxes: (scene left , right , rear ; separate light /sound)

- 4 x 63 A CEE 5-pol 6h
- 7 x 32 A CEE 5-pol 6h
- 5 x 16 A CEE 5-pol 6h
- 21 x Schuko
- DMX

Operating rooms for external productions

- 2 x 400 A 3P/N/PE on M12 stay bolts
- 2 x 125 A CEE 5-pol 6h
- DMX

Distributed for Scene lighting in the upper circle:

- 9 x Harting junction boxes, HAN 16

Feed- in power operating room

- 9 x Schuko 16 A
- 1 x 63 A CEE 5-pol 6h
- 1 x 32 A CEE 5-pol 6h
- DMX

The available total capacity is to be coordinated with the Tempodrom Technical Management.

DELIVERIES

Access to the Arena / stage level via a ramp
(width 3.25 m, height 4.4 m, gradient 12.5%)

TELECOMMUNICATIONS

- WLAN
 - Connection option for analogue telephones
- 1 ISDN-connection over S0-Bus of the house-internal network is available
- Fibre optic connection
 - PA system(alarm, announcements, gong)

GENERAL PLAN RIGGING POINTS

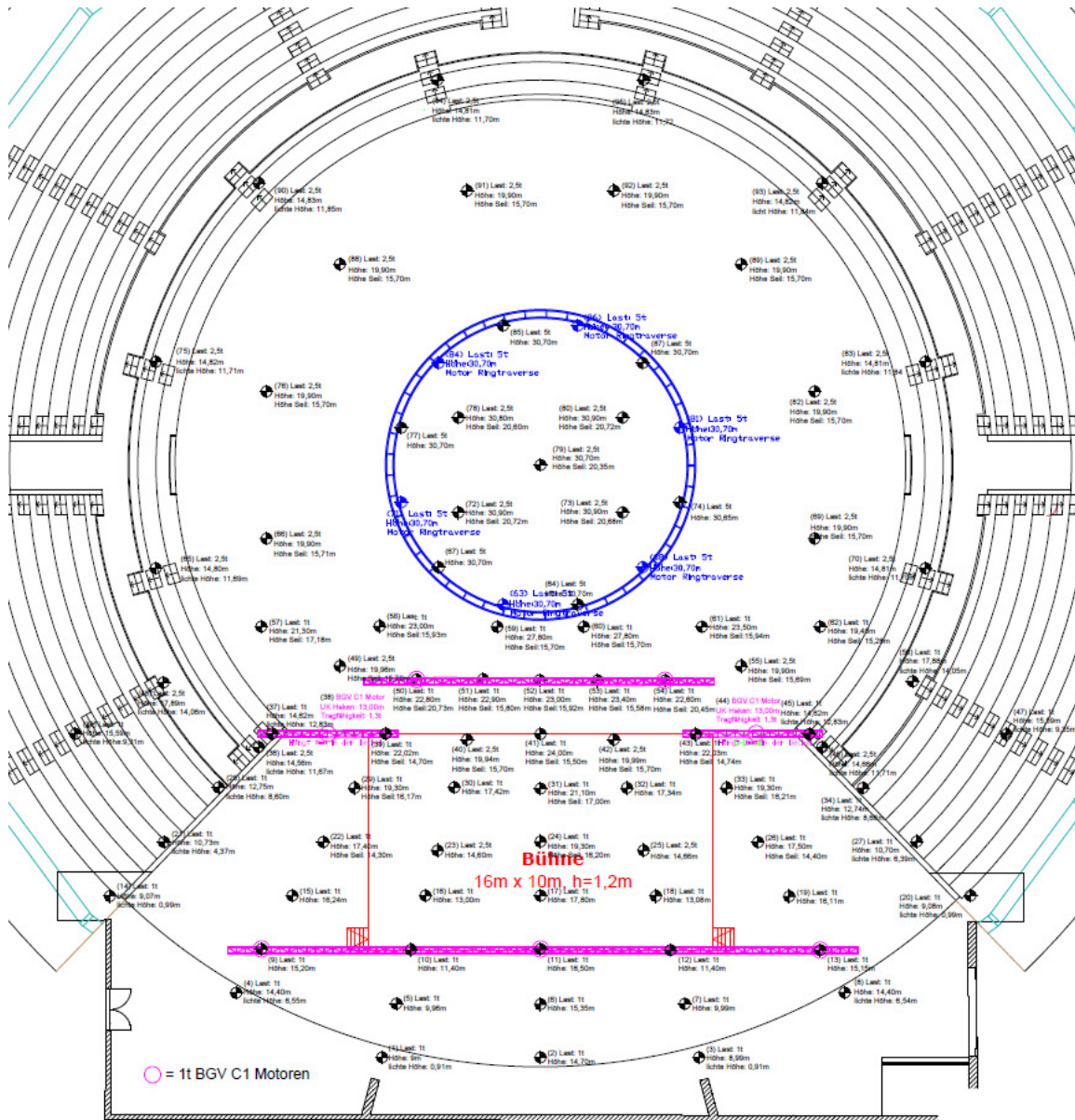

see also overview diagrams on the last pages

SEATING OPTIONS

OPTION A 1 - FULL SEATING With partially extended mobile stand

Scene

Scene diameter circus ring	25 m
Scene rear area	160 m ²
Scene area	470 m ²
clear height	9,3 – 29,4 m

Audience capacity

Upper circle	1718 Seats
Lower circle	660 Seats
Circus ring	744 Seats
Total	3122 Seats

plus 11 wheelchair users
with attendant

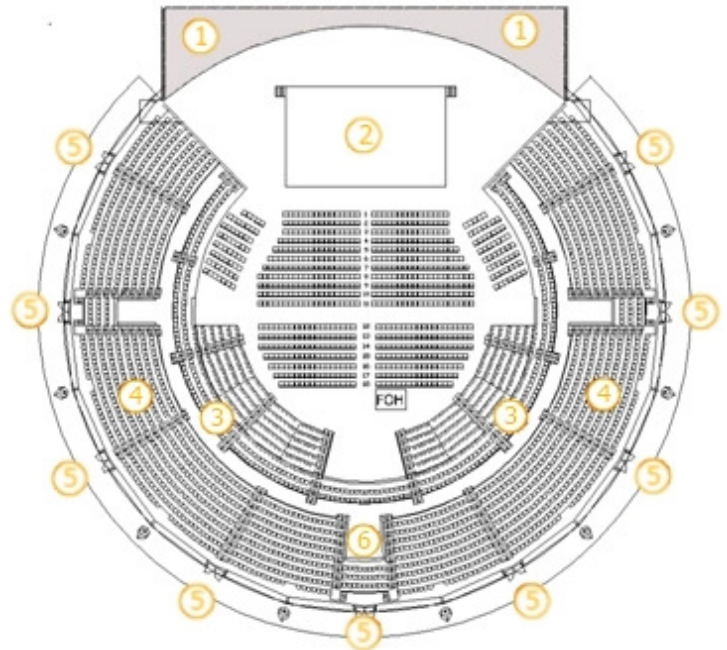

- 1 Scene rear area
- 2 Standard stage (16 x 10 x 1.20 m)
- 3 Lower circle
- 4 Upper circle
- 5 Access to roof terrace
- 6 Foyer entrance
- 7 Circus ring
- 8 Wheelchair Podest
- 9 Bar

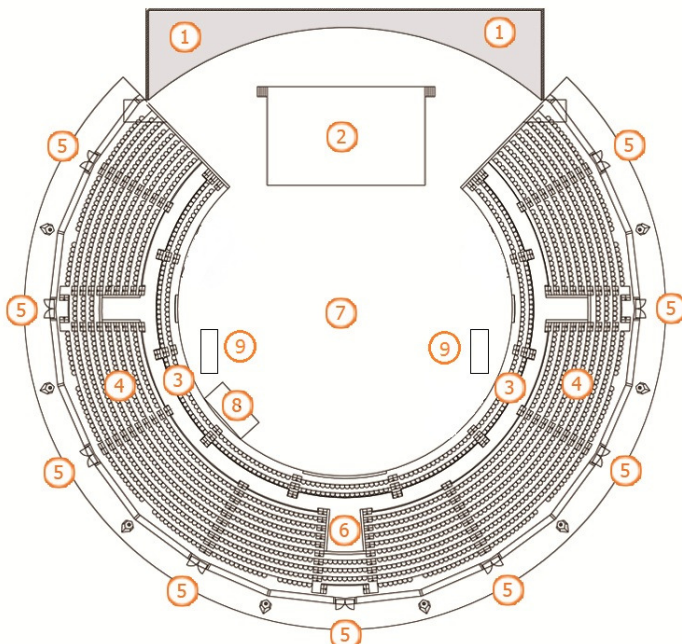

OPTION A 2 - STANDING ROOM With retracted mobile stand

Scene

Scene diameter circus ring	33,5 m
Scene rear area	160 m ²
Backstage area	470 m ²
Clear height	9,3 – 29,4 m

Audience capacity

Upper circle	1718 Seats
Lower circle	308 Seats
Circus ring	1450 Standing room

Total 3476 Places

plus 35 wheelchair users
with attendant; 1% in acc.
with BetrVO § 26

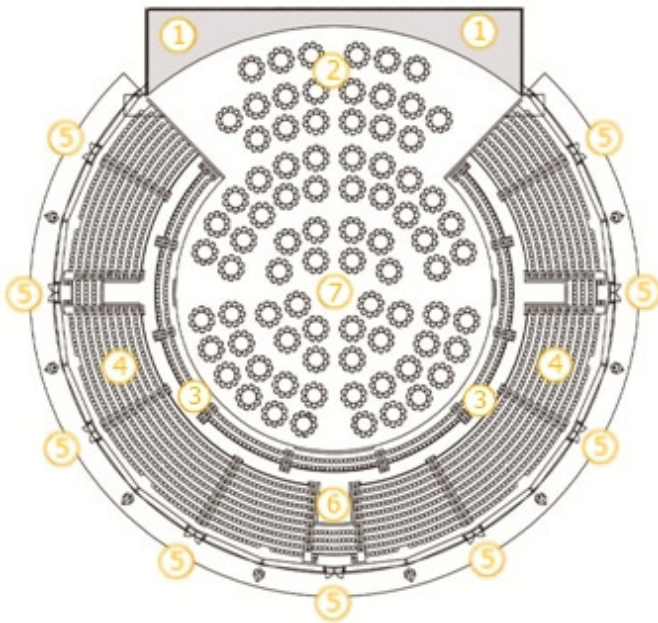

OPTION A 3 - GALA DINNER
Round tables, diameter 1.80 m

Scene

Diameter circus ring 33,5 m
Scene rear area 160 m²
Clear height 9,3 – 29,4 m

Number of seats
Without upper circle

Circus ring 820 Seats

Total 820 Seats

- 1 Scene rear area
- 2 Scene area
- 3 Lower circle
- 4 Upper circle
- 5 Access to roof terrace
- 6 Foyer entrance
- 7 Table seating

OPTION A 4 - GALA DINNER
Long tables (1.20 m x 0.80 m)

Scene

Diameter circus ring 33,5 m
Scene rear area 160 m²
Clear height 9,3 – 29,4 m

Number of seats
Without upper circle

Circus ring 1024 Seats

Total 1024 Seats

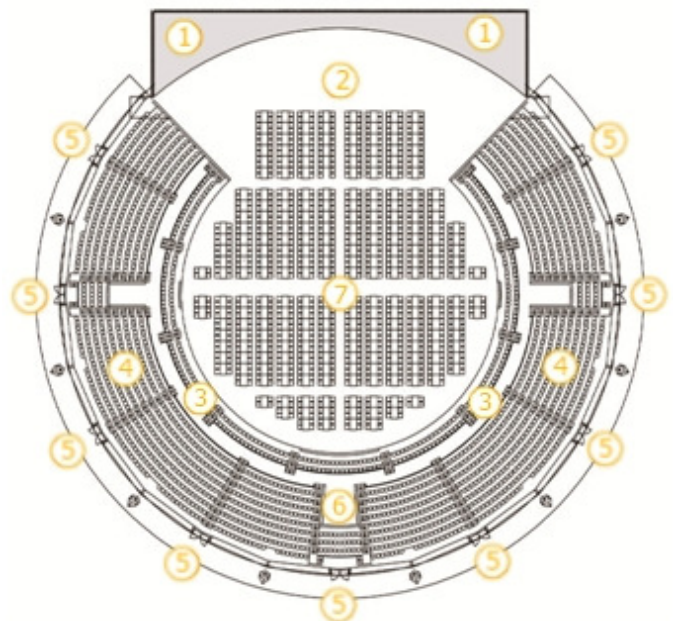

**OPTION A 5 - CONFERENCE
PARLIAMENTARY**
(1,20 m x 0,40 m / 1,20 m x 0,80 m)

Scene

Diameter circus ring	33,5 m
Scene rear area	160 m ²
Backstage area	470 m ²
Clear height	9,3 – 29,4 m

Number of seats
Without upper circle

1,20 m x 0,40 m Circus ring	672 Seats
--------------------------------	-----------

Total	672 Seats
--------------	------------------

1,20 m x 0,80 m Circus ring	524 Seats
--------------------------------	-----------

Total	524 Seats
--------------	------------------

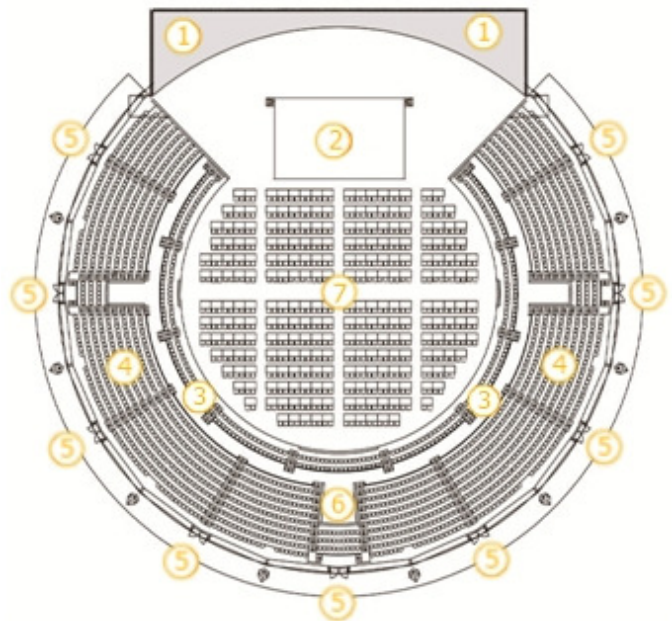

- 1 Scene rear area
- 2 Scene area / standard stage 16 x 10 x 1.20 m
- 3 Lower circle
- 4 Upper circle
- 5 Access to roof terrace
- 6 Foyer entrance
- 7 Table seating
- 8 Rowed seating

**OPTION A 6 - CONFERENCE
ROWED SEATING**

Scene

Diameter circus ring	33,5 m
Scene rear area	160 m ²
Scene area	470 m ²
Clear height	9,3 – 29,4 m

Number of seats
Without upper circle

Circus ring	1052 Seats
-------------	------------

Total	1052 Seats
--------------	-------------------

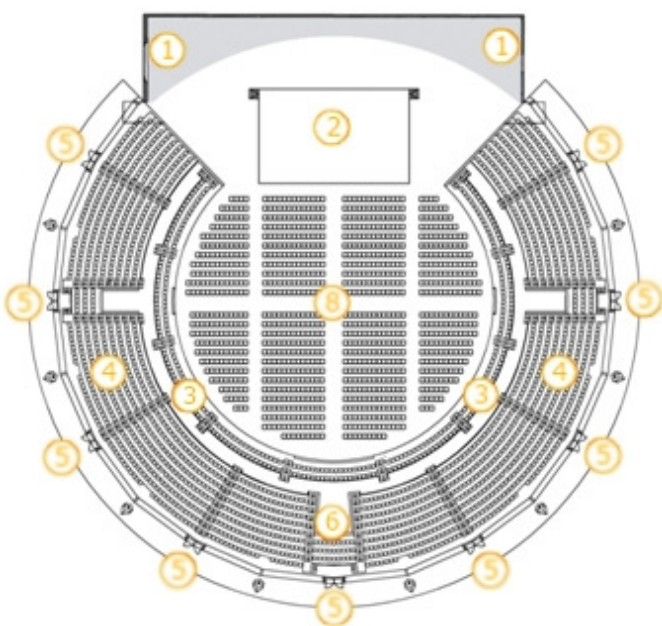

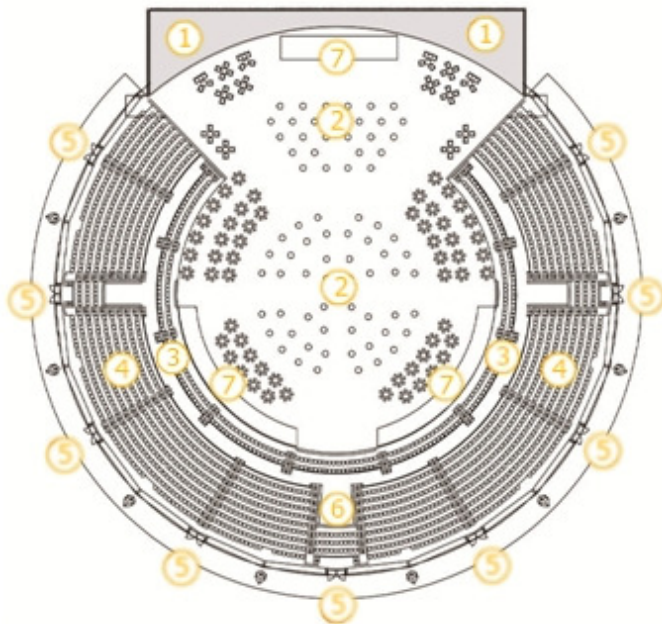

OPTION A 7 - RECEPTION

without upper circle

Scene

Diameter circus ring	33,5 m
Scene rear area	160 m ²
Clear height	9,3 – 29,4 m

Number of seats

Circus ring	1300 Standing 466 Seats
-------------	----------------------------

Total	1766 Spaces
-------	-------------

- 1 Scene rear area
- 2 Scene area / action space
- 3 Lower circle
- 4 Upper circle
- 5 Access to roof terrace
- 6 Foyer entrance
- 7 Gastronomy area

OPTION A 8 - SPORT
With special stands

Scene

Diameter circus ring	33,5 m
Scene rear area	160 m ²
Scene area	550 m ²
Clear height	9,3 – 29,4 m

Audience capacity

Upper circle	1691 Seats
Lower circle	308 Seats
Circus ring	528 Seats

Total	2527 Seats
-------	------------

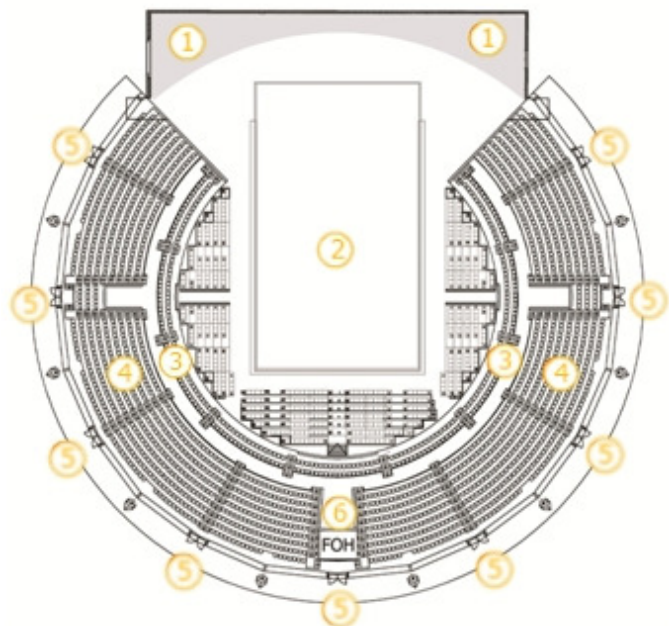

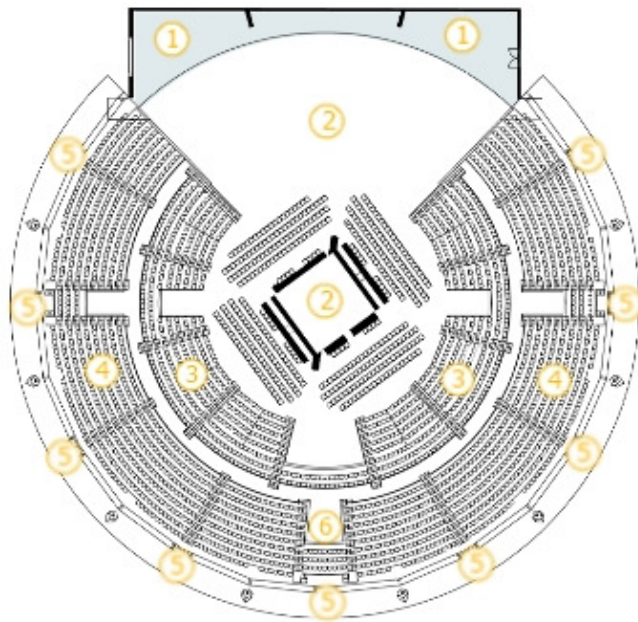

OPTION A 9 - BOXING / WRESTLING

Scene

Diameter circus ring	25 m
Scene rear area	160 m ²
Scene area / Ring	55 m ²
Clear height	9,3 – 29,4 m

Audience capacity

Upper circle	1718 Seats
Lower circle	856 Seats
Circus ring	302 Seats

Total 2876 Seats

Plus 29 wheelchair users with attendant; 1% in acc. with BetrVO § 26

- 1 Scene rear area
- 2 Scene area / action area
- 3 Lower circle
- 4 Upper circle
- 5 Access to roof terrace
- 6 Foyer entrance
- 7 Stage trolley

OPTION A 10 – CIRUS SEATING
With extended mobile stand

Scene

Diameter circus ring	25 m
Scene rear area	160 m ²
Scene area / Arena	85 m ²
Clear height	9,3 – 29,4 m

Audience capacity

Upper circle	1718 Seats
Lower circle	856 Seats
Circus ring	262 Seats

Total 2836 Seats

Including 29 wheelchair users with attendant; 1% in acc. with BetrVO § 26

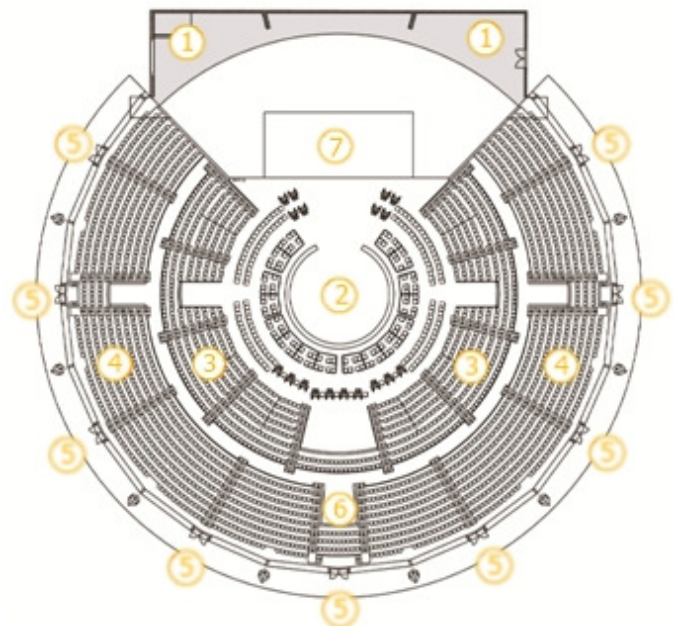

BLOCK OVERVIEW BIG ARENA

Capacity reduction
e.g. through FOH, follow spots and space for wheelchair users;
in acc. with BetrVO § 26 (4) 1% of the total capacity plus attendants.

Please determine the exact capacity for your event in cooperation with the Tempodrom Technical Management!

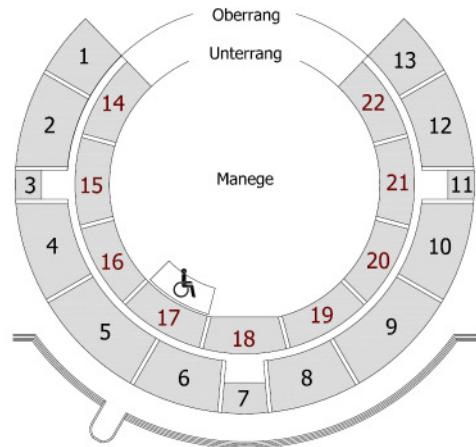
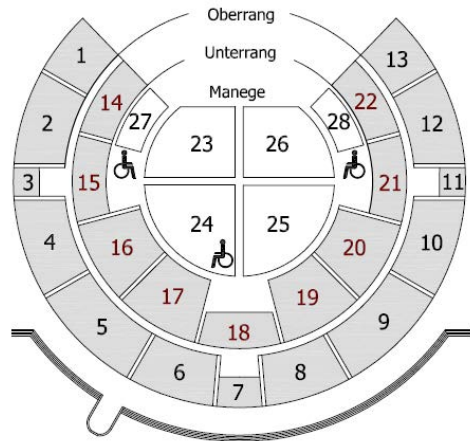

SEATING CAPACITIES

BLOCK NO.	SEATS
UPPER CIRCLE	1718
1	105
2	177
3	15
4	177
5	208
6	164
7	27
8	163
9	208
10	177
11	15
12	177
13	105
LOWER CIRCLE	660
14	31
15	53
16	114
17	114
18	36
19	114
20	114
21	53
22	31
CIRCUS RING	744
23	195
24	123
25	123
26	195
27	54
28	54
TOTAL SEATS	3122

SEATING CAPACITIES

BLOCK NO.	SEATS
UPPER CIRCLE	1718
1	105
2	177
3	15
4	177
5	208
6	164
7	27
8	163
9	208
10	177
11	15
12	177
13	105
LOWER CIRCLE (ROWS 7&8)	308
14	31
15	35
16	35
17	35
18	36
19	35
20	35
21	35
22	31
TOTAL SEATS	2026
CIRCUS RING STANDING ROOM	1450
TOTALCAPACITY	3476

B SMALL ARENA

DESCRIPTION

The circular Small Arena is located in the western part of the building. The room is ideal for smaller scale product presentations, press conferences, parties and concerts. The basic area of the Small Arena is 1.32 m below foyer level and can be transformed into a closed event area through mobile partitions with its own foyer, backstage area, bars and public toilets. Clear height at the centre of the room is 5.50 m, with a total diameter of 18.82 m.

WALLS

The walls are of decorated exposed concrete. Through mobile partitions on ceiling rails, the Small Arena can be opened into the main foyer. This creates a generously-sized event venue that includes the circus ring of the Small Arena.

CEILING

The circular suspended ceiling is formed like a cascade extending upwards. Lighting elements, various anchor points for traverses, a ring traverse and junction boxes for power connections are integrated.

FLOOR

The flooring of the Small Arena is smoothed mastic asphalt. The surrounding curved seating steps are equipped with cushions as required.

EQUIPMENT

The round form of the Small Arena can be used for circus and for stage performances with an individually designed stage. The inventory includes a permanently installed red velvet curtain on the inside of the walls that can be completely closed. To install the event technology, a ring traverse with corresponding junction boxes is available.

To the rear of the Small Foyer is a fully-equipped bar.

In the backstage area are the connections for event technology as well as a WC with basin. The Small Arena area has its own public toilet facilities.

- 1 Small Arena (250m²)
- 2 Foyer Small Arena (115m²)
- 3 Bar
- 4 Backstage Small Arena (35m²)
- 5 Entry Small Arena
- 6 Ticket booth
- 7 WC Gentlemen
- 8 WC Ladies
- 9 Mobile partitions
- 10 Foyer Big Arena

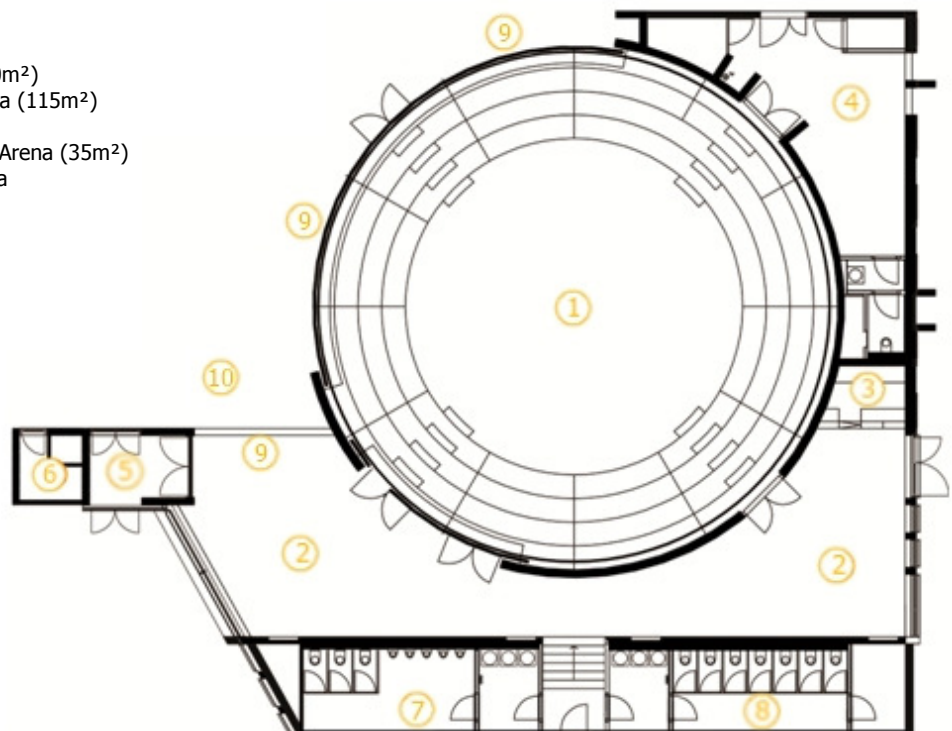

TECHNICAL EQUIPMENT

- 24 rigging points
Load capacity per 250 kg
max. ceiling load 2.000 kg
- 1 ring truss with transverse cross bar
- four belt traverse system 29 x 29 cm
 - external radius 10 m
 - max. load capacity: 800 kg

BASIC PACKAGE LIGHT

This package is suited for the basic areal lighting of the Small Arena with LED floodlights, for creating accents with LED spotlights and lighting the stage with Fresnel-lense and profile spotlights. A scenic control of the lighting equipment is not provided for, only the calling-up of presets in the backstage area of the Small Arena. In addition, 6 unmounted small LED spotlights are included, which may be used as up-lights in stand-alone operation.

Permanently installed technical devices included (as of 2014)

- 16 x LED PAR
- 4 x LED floodlights
- 8 x Fresnel-lense spotlights 1kW
- 4 x ETC S4 Junior profile spotlights
- 6 x LED PAR (unmounted)

Further standard equipment for diverse event formats may be booked in addition.

GENERAL PLAN RIGGING POINTS

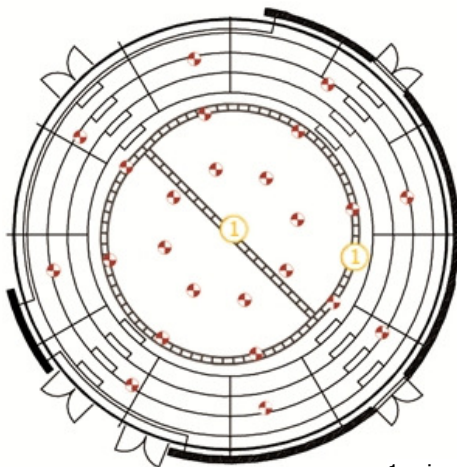

1 ring truss

BASIC PACKAGE AUDIO – SOUND

Standard sound system for small to medium

volume, particularly suited for voice and music applications. For all other applications additional packages must/can be added.

Permanently installed technical devices included (as of 2015)

- 4 x top EAW KF 300 in flying bracket
- 4 x bass EAW SB 330
- 4 x small loudspeakers EAW UB 12S in flying bracket
- 1 x amping, crossover and cable PA system
- 1 x CD / MP3 player in the Small Arena's backstage area

POWER CONNECTIONS

Foyer area

- 4 floor tanks with 2 Schuko each

Small Arena

- 2 x 16 A CEE 5-pol 6h
- 4 x Schuko

Backstage Small Arena (separate light /sound)

- 1 x 125 A CEE 5-pol 6h
- 1 x 63 A CEE 5-pol 6h
- 2 x 32 A CEE 5-pol 6h
- 1 x 16 A CEE 5-pol 6h
- 6 x Schuko
- DMX

The maximum available capacity is to be agreed with the Tempodrom Technical Management.

TELECOMMUNICATIONS

- WLAN
- Connection option for analogue telephones
- 1 ISDN-connection via S0-Bus of the house-internal connection
- Fibre optic connection for Small Arena & backstage
- PA system (alarm, announcements, gong)

SEATING OPTIONS

OPTION B 1 – FULL SEATING

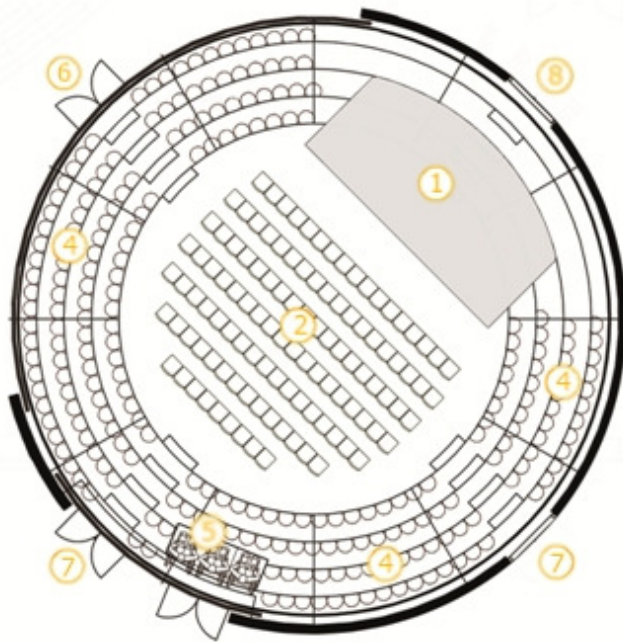

Scene

Diameter circus ring	11,50 m
Standard stage	8 x 4 m
Clear height	5,50 m

Audience space

Spaces on seating steps	228 Seats
Seating circus ring	111 Seats
Wheelchair users	4 Spaces

Total 343 Spaces

Including 4 wheelchair users with attendant; 1% in acc. with BetrVO § 26

- 1 Standard stage 8 x 4 m
- 2 Circus ring seating
- 3 Scene area circus ring
- 4 Seating steps
- 5 Wheelchair platforms
- 6 Access to Foyer Big Arena
- 7 Access to Small Arena foyer
- 8 Access backstage

OPTION B 2 – STANDING ROOM

Scene

Diameter circus ring	11,50 m
Stage	8 x 4 m
Scene area circus ring	90 m ²
Clear height	5,50 m

Audience space

Spaces on seating steps	228 Seats
Spaces in circus ring	172 Spaces
Wheelchair users	4 Spaces

Total 403 Spaces

Including 4 wheelchair users with attendant; 1% in acc. with BetrVO § 26

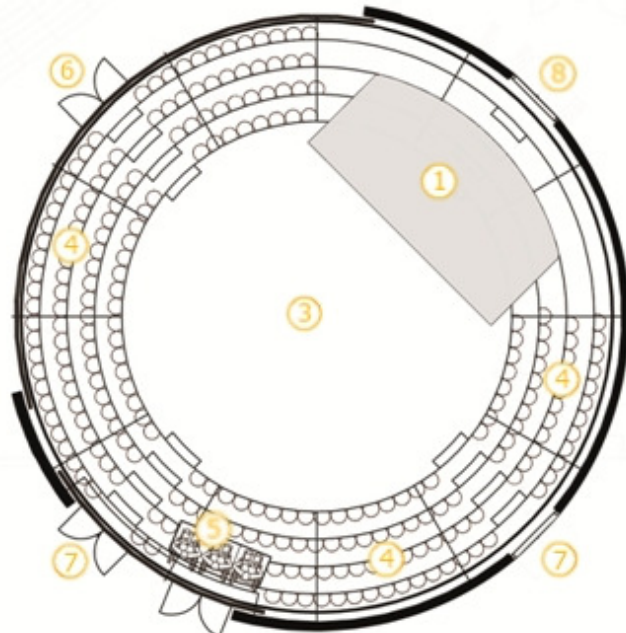

The seats and capacity of your events can deviate from the variants presented here. You determine specific numbers in co-operation with the technical management of the Tempodrom.

C FOYER

DESCRIPTION

The 1,000 m² Foyer extends over three floors and offers sufficient space for use as exhibition, reception or gastronomy area for approx. 1,200 visitors

Via a free-standing semi-circular staircase, visitors can access the centre entry to the Big Arena.

The cloakroom area, toilets and the circus ring of the Big Arena are located on the basement floor. All public facilities in the building are accessed from the Foyer and are suitable for wheelchair access.

The total of six min entry doors to the Foyer each have a width of 2.18m.

CEILINGS

The Foyer ceilings are partially of exposed concrete and partially painted dark red. Lighting elements, anchor points for traverses, PA system speakers and sprinklers are integrated. All skylights in the ceiling are connected to the roof terrace and include integrated lighting elements. The ceiling has a height of 4.21 m.

FLOOR

The floor is smoothed mastic asphalt with integrated floor tanks, which are equipped with power telecommunication connections.

The stairs running around the Big Arena are constructed of exposed concrete blocks.

EQUIPMENT

The bar counters with power connections, water supply and drains, sinks, fridges and work areas as well as merchandising stands with power and telephone connections are grouped in a semi-circle around the Big Arena. The bar counters and wall niches with seating are manufactured from wood.

All levels of the building are suitable for wheelchair access through a centrally accessed lift.

TECHNISCHE AUSSTATTUNG

- 8 rigging points per 250 kg load capacity

POWER CONNECTION & TELECOMMUNICATIONS

Distributed between 12 floor tanks:

- WLAN
- connections for analogue telephones
- 1 ISDN-connection via S0- Bus in-house network available
- Fibre optic connection
- 12 x Schuko
- PA system (alarms, announcements, gong)

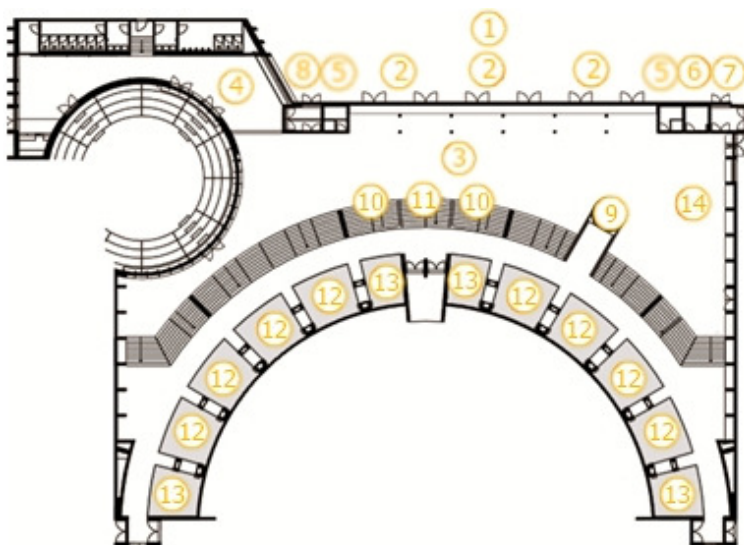

- 1 Forecourt
- 2 Visitor entrances
- 3 Foyer ground floor (1000m²)
- 4 Foyer Small Arena (115m²)
- 5 Ticket desk
- 6 Fire alarm centre
- 7 Restaurant / Staff entrance
- 8 Entrance Small Arena
- 9 Lift
- 10 Access to public cloakroom basement/ lower circle/circus ring
- 11 Entrance upper circle
- 12 Gastronomy
- 13 Kiosks for merchandising
- 14 Additional merchandising area

D LOUNGE

DESCRIPTION

Linked to the western side of the foyer area and Backstage West is the Lounge. The unique architecture of this room, the curved layout, the cascade-formed rising ceiling as well as dimmable lighting lend the Lounge its special character.

WALLS

The walls are painted dark red in part and partially left in an exposed concrete optic.

CEILINGS

The stepped-form ceiling of the room is of decorated exposed concrete. The PA-system speakers are integrated in this.

FLOOR

The floor is of smoothed mastic asphalt.

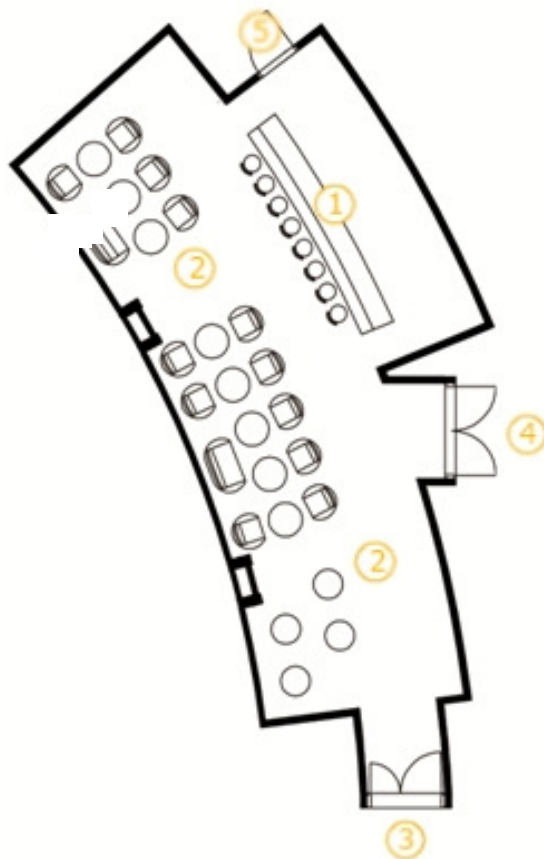

EQUIPMENT

The Lounge inventory includes a high-quality bar counter, bar stools and tables, 10 luxurious armchairs and 2 double sofas of black leather. In addition there are 2 round stainless steel and milk glass tables, as well as a variety of dark wooden tables.

The Lounge has a fully-equipped bar area with water supply and drainage, power, sinks and two fridges.

- WLAN
- 1 ISDN-connection available via the S0-Bus of the house-intern network
- dimmable lighting
- PA-system (alarms, announcements, gong)
- 2 active speakers with 3.5 mm jack (behind the bar)

- 1 Bar
- 2 Lounge (100m²)
- 3 Foyer entrance
- 4 Backstage West entrance
- 5 House technology

E FORECOURT/ OUTDOOR AREA

DESCRIPTION

With its 1,500 m² Tempodrom offers an outdoor area which offers space to the most varied of event concepts. The forecourt can be used as for VIP arrivals, for a cloakroom tent or as a catering area.

As parts of the forecourt and the western drive serve as emergency service access, these may not be used for parking. Power connections are located on both sides of the forecourt on the building facade. A further power supply is located next to the entrance to the Big Arena on the eastern side of the building. This also serves as a media connection for OB vans or tour busses.

FLOOR

The forecourt and surrounding areas are sealed with an asphalt surface.

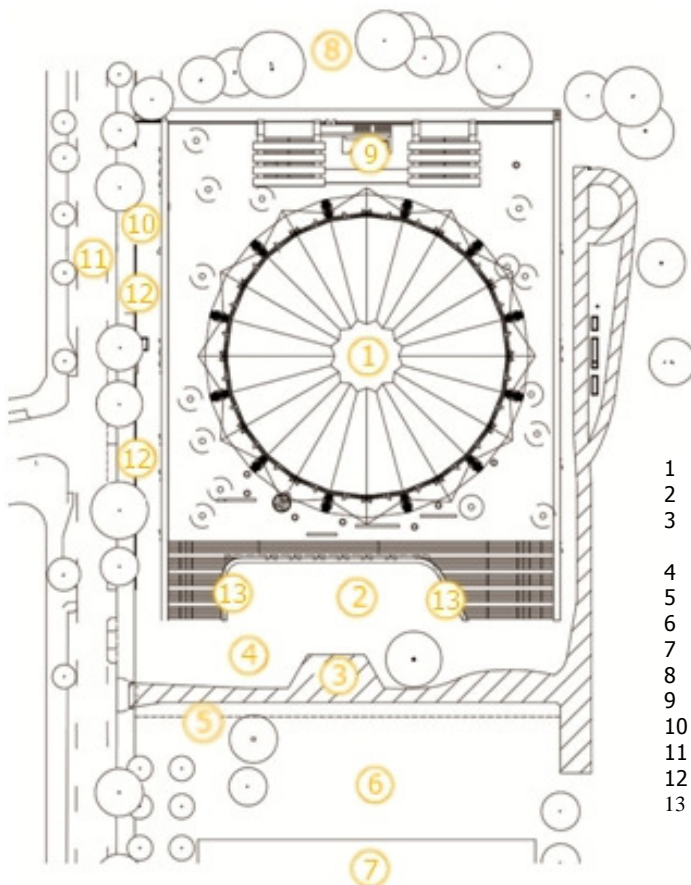

TECHNICAL EQUIPMENT ELECTRICITY CONNECTIONS & TELECOMMUNICATIONS

Forecourt:

- 1 x 63 A CEE 5-pol 6h
- 1 x 32 A CEE 5-pol 6h
- 2 x 16 A CEE 5-pol 6h
- 2 x Schuko
- Connection for analogue telephones available
- 1 ISDN- connection available via the S0-Bus of the house-internal network
- Fibre optic connection

West side:

- 1 x 63 A CEE 5-pol 6h

Access Big Arena/ east side

- 1 x 125 A CEE 5-pol 6h
- 1 x 63 A CEE 5-pol 6h
- 1 x 32 A CEE 5-pol 6h
- 1 x Schuko
- Connection for analogue telephones available
- 1 ISDN connection via S0-Bus of the house-intern network

- 1 Tempodrom
- 2 Forecourt (1500m²)
- 3 Emergency services manoeuvring area
- 4 Velo paths
- 5 Disabled parking spaces
- 6 Lawn
- 7 Sport ground
- 8 City wood
- 9 Patio Liquidrom
- 10 loading ramp access
- 11 Möckernstraße
- 12 Parking for OB vans / tour busses
- 13 Forecourt junction boxes

F ROOF TERRACE

DESCRIPTION

As ideal addition to the venues inside the Tempodrom there is also a roof terrace with over 3,000 m².

This open-air space surrounds the impressive roof and is entirely covered in wooden flooring (surface load 500 kg/m²). From the upper circle of the Big Arena the roof terrace can be directly accessed via nine fully glazed double-winged doors. The area is also accessed from the building forecourt by a wide open-air staircase.

From spring to autumn, Tempodrom provides the ideal location for combined indoor and outdoor events.

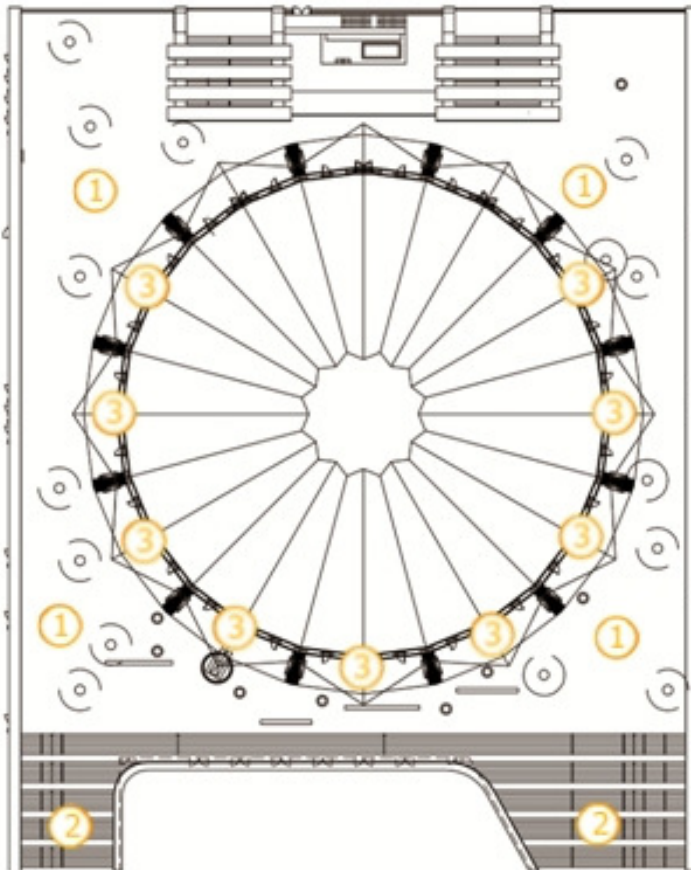

TECHNICAL EQUIPMENT

Distributed between 10 floor tanks:

- 6 x water supply
- 5 x waste water drains
- 8 x Schuko
- 3 x 32 A CEE 5-pol 6h
- 1 x 16 A CEE

- 1 roof terrace (3000m²)
- 2 outdoor staircase/roof terrace access
- 3 access to the Big Arena /roof terrace

G BACKSTAGE EAST

DESCRIPTION

The backstage area located to the east of the Scene store consists of three dressing rooms, showers, WCs, a VIP dressing room, two production offices and a tea kitchen.

A generous central area with flexible, production-related use is available, for example as a crew area.

Offices 1 & 2 are provided with telephone and data connections; the VIP dressing room also has its own bathroom with shower and WC. Dressing Rooms 4 and 6 have direct access to the respective WC and shower rooms. Furniture such as tables, chairs, sofas and mirror are available in sufficient quantities. A corresponding inventory list is available upon request.



- | | |
|----|-------------------------------------|
| 1 | Office 2 (6m ²) |
| 2 | Office 1 (6m ²) |
| 3 | Dressing Room 3 (12m ²) |
| 4 | Toilets Ladies |
| 5 | Dressing Room 4 (6m ²) |
| 6 | Dressing Room 5 (8m ²) |
| 7 | Dressing Room 6 (6m ²) |
| 8 | Toilets Gentlemen |
| 9 | Crew area (100m ²) |
| 10 | Tea kitchen |
| 11 | Access to the Big Arena |

TECHNICAL EQUIPMENT

- WLAN

Production office east 1 & 2:

- 2 telephone connections
- various Schuko
- TV & radio connections

VIP dressing room:

- 2 telephone connections
- various Schuko
- TV & radio connections

Cloakrooms 1, 2, 3:

- various Schuko

Crew area:

- 2 telephone connections
- various Schuko
- TV & radio connections
- Fibre optic lines

Tea kitchen:

- various Schuko
- 1 refrigerator

H BACKSTAGE WEST – DRESSING ROOM 1

DESCRIPTION

There is an additional dressing room in the western area of the building with direct access backstage on the basement level. The 35m² room in red is fitted with comfortable sofas and seating cubes, two illuminated make-up mirrors and tables and two oversized wall mirrors. WCs and showers are in direct proximity

TECHNICAL EQUIPMENT

- 3 x double wall mounted schukos
- WLAN
- 2 telephone/data connections
- TV/radio connection

FURNITURE

- 2 sofas
- couch table
- various cube seats
- 2 make-up mirrors with table
- 2 wall mirrors 1 x 2 m
- further furniture available upon request

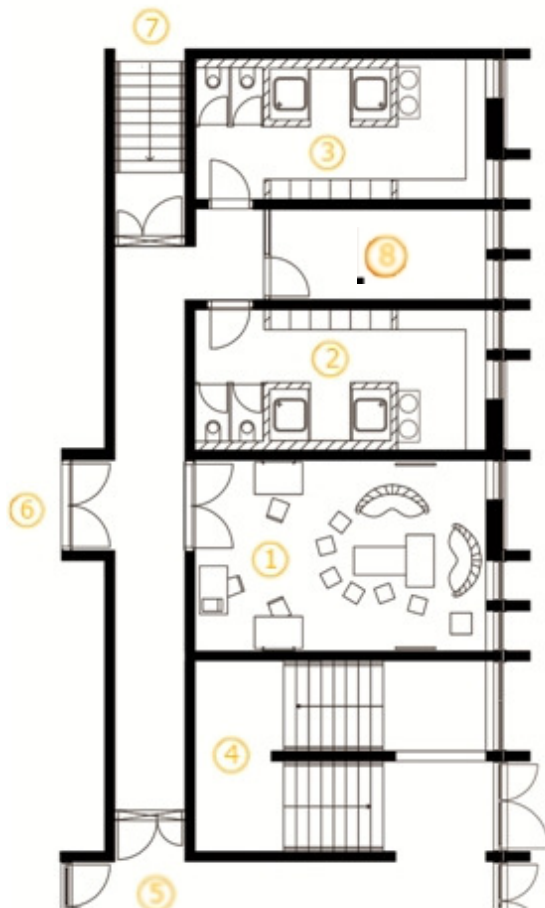

- | | |
|---|---------------------------------------|
| 1 | Dressing Room 1 (35m ²) |
| 2 | Bathroom Women |
| 3 | Bathroom Men |
| 4 | Entrance Big Arena lower circle |
| 5 | Entrance Big Arena upper circle |
| 6 | Entrance Lounge |
| 7 | Entrance backstage |
| 8 | Dressing Romm 1b (12 m ²) |

I BACKSTAGE WEST – CATERING, DRESSING ROOM 2

DESCRIPTION

The kitchen located on the west side with connected crew catering room, as well as Dressing Room 2 have an expansive window front. Due to their proximity to the Big Arena, Small Arena and the lounge, as well as equipment with telecommunications technology, these are predestined for use as workshops or production offices for large events. They offer room for 40 to 100 people. In the kitchen, a fully-equipped kitchenette is available. The catering area, equipped with marquee fittings can be separated from the kitchen with suspended partitions.

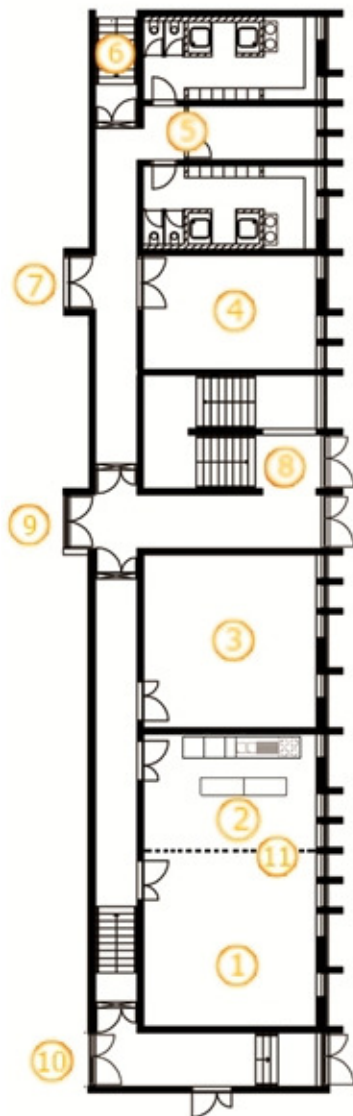

- 1 Catering (50m²)
- 2 Kitchen (35m²)
- 3 Dressing Room 2(50m²)
- 4 Dressing Room 1 (35m²)
- 5 Bathrooms/ Dressing Room 1b (12m²)
- 6 Access to backstage area
- 7 Lounge entrance
- 8 Entry to Big Arena lower circle
- 9 Entry to Big Arena upper circle
- 10 Foyer entrance
- 11 Mobile partition

TECHNICAL EQUIPMENT

CATERING

- Cooker (4 hotplates & oven)
- Roasting pan
- Double sink
- dishwasher
- 2 Fridges
- 2 Stainless steel workbenches
- Partition elements

- WLAN
- 1 ISDN connection available via the S0-Bus of the house-internal network
- dimmable lighting
- PA system (alarm, announcements, gong)
- several Schuko sockets
- 1 x 32 A CEE 5-pol 6h

Distributed between 4 floor tanks:

- 2 x double schuko
- 4 telephone/data connections
- Fibre optic connection
-

DRESSING ROOM 2

- 1 x Schuko 16 A, wall-mounted

Distributed between 3 floor tanks:

- 2 x double schuko
- WLAN
- 4 telephone/data connections
- Fibre optic connection

SERVICEPARTNER

CATERING

Sarah Wiener Berlin GmbH
Charlottenstraße 13
10969 Berlin

Fon +49 (0)30 707180-0
Fax +49 (0)30 707180-229

E-mail info@sarahwiener.de
Internet www.sarahwiener.de

FIRE PREVENTION / PARAMEDICS

Brandschutzbüro und Dienstleistungen
Behring GmbH
Geflügelsteig 78
12355 Berlin

Fon +49 (0)30 66 46 02 - 05
Fax +49 (0)30 66 06 84 - 60

E-mail kontakt@behring.biz
Internet www.behring.biz

EVENT ENGINEERING + RIGGING + SHOW ELECTRONICS

TSE AG · Technik und Service für Events AG
Sound-, Light-, Stage- engineering,
Video- and Conference-engineering
Bergiusstrasse 52
12057 Berlin

Fon +49 (0)30 39 06 1 - 0
Fax +49 (0)30 39 06 1 - 199

E-mail info@tse-ag.com
Internet www.tse-ag.com

CLEANING

GRG Services Berlin
Markstraße 35-37
13409 Berlin

Fon +49 30 49009-200
Fax +49 30 49009-299

E-Mail berlin@grg.de
Internet www.grg.de

SECURITY

B.E.S.T. Veranstaltungsdienste GmbH
Stieffring 6
D-13627 Berlin

Fon +49 (0)30 34 34 67 - 0
Fax +49 (0)30 34 34 67 - 67

E-mail info@bestvd.de
Internet www.bestvd.de

INFORMATION FOR EVENT ORGANISERS

FIRE BRIGADE / PARAMEDICS

For events in the Tempodrom Big Arena it is mandatory that from opening of the event to the public, the presence of 3 fire prevention officers from the fire brigade is required. Block 8, row 1, seat 1 is reserved for fire prevention monitoring in the audience area. This seat is to be omitted from ticket sales! Furthermore, the presence of 2 paramedics is also required for events in the Big Arena.

SHOW ELECTRICIANS

For reasons of operating safety, the show electrician must be present at least 1 hour prior to the show commencing and remain present until the end of the event. The requirement for the electrician during the technical set-up work is oriented on the type of event and is to be decided upon consultation with Tempodrom.

HALL INSPECTOR

The presence of the Tempodrom hall inspector is essentially required for the duration of the event (admission to the end) as well as for set-up and disassembly in accordance with BetrVO §32. The instructions of the Hall Inspector are to be complied with.

SECURITY STAFF

Tempodrom has concluded an exclusivity contract with B.E.S.T. Veranstaltungsdienste GmbH Berlin. The number of staff is orientated on the type of event, the anticipated number of visitors and is to be determined upon consultation with B.E.S.T. and Tempodrom Technical Management.

CLOAKROOM ATTENDANTS

Tempodrom has its own staff to provide cloakroom services. The number of employees is based on the type of event and is determined by Tempodrom.

POWER CONTROL ROOM

The power operating room is located stage left in the Big Arena for the power connections and event technology. This is required in accordance with building regulations and serves to house the dimmer control panel during the event. Through a firewall closable with a fire retardant block, cable lines can be set-up for installation. All cable lengths, multicore and extensions must be measured in a manner that the dimmer control cupboards in the power control room can be adjusted. A wiring plan for the Big Arena can be obtained from the Tempodrom Technical Management.

CAPACITY & TICKET SALES

In accordance with BetrVO Berlin §26, para. 4 1% of audience space is to be reserved for wheelchair users, however with a minimum of 2 spaces. These are to each be allocated a seat for attendants. For this reason and through the event technology installation (FOH, follow spots, camera spaces etc.) as well as further seats blocked for the event organiser, there is an individual total capacity for each individual event. Therefore please assess the total capacity for ticket sales in cooperation with the Tempodrom Technical Management.

PARKING PERMISSION

Parking permission for tour busses, lorries and OB vans must be applied for from Tempodrom at least two weeks prior to the start of use. With special permission, a maximum of 110 m may be applied for. (Park zones A, B, D see page 37)

DECORATION & FITTINGS

All decorations, fittings, furnishings as well as stands and info boxes must have at least B1 certification in accordance with DIN 4102. This certificate must be issued to the Tempodrom Technical Management 4 weeks prior to the start of the event.

FORECOURT

Sections of the forecourt and the western vehicle access to the Tempodrom serve as emergency service access or manoeuvring areas. It is therefore not possible to use the forecourt for parking. Exceptions from this parking prohibition are possible for delivery traffic for the Small Arena and the foyer, however only up until one hour prior to the start of admission to the events. In cooperation with the Tempodrom Technical Management vehicle access during special events is possible.

PREPARATION, PERMITS & IMPLEMENTATION

The Tempodrom team are at your disposal for the professional planning, preparation, authorisation and implementation of your event. We advise that the permit procedure for corporate events with the building authority must be applied for at least 4 weeks prior to the respective event. Please coordinate all requirements with the Tempodrom Technical Management.

PUBLIC AUTHORITY

BUILDING AUTHORITY

Bezirksamt Friedrichshain-Kreuzberg von Berlin
Amt für Stadtplanung, Vermessung und Bauaufsicht
Yorckstraße 4 - 11, 10965 Berlin

Contact person

Herr Becker

Fon +49 (0) 30 902 98 - 3311

Fax +49 (0) 30 902 98 - 2958

E-Mail reinhard.becker@ba-fk.verwalt-berlin.de

ENVIRONMENTAL OFFICE

Bezirksamt Friedrichshain-Kreuzberg von Berlin
Abt. Stadtentwicklung und Bauen
Amt für Umwelt und Natur
Fachbereich Umwelt
Yorckstraße 4 - 11, 10965 Berlin

Fon +49 (0) 30 902 98 - 4411

Fax +49 (0) 30 902 98 - 2727

PARKS AUTHORITY

Bezirksamt Friedrichshain-Kreuzberg von Berlin
Abt. Stadtentwicklung und Bauen
Amt für Umwelt und Natur
Fachbereich Naturschutz und Grünflächen
Yorckstraße 4 - 11, 10965 Berlin
Postfach 350701, 10216 Berlin

Contact person

Frau Keller

Fon +49 (0) 30 902 98 - 8024

Fax +49 (0) 30 902 98 - 8033

E-Mail natur@ba-fk.verwalt-berlin.de

LAGETSI

Landesamt für Arbeitsschutz, Gesundheitsschutz
und technische Sicherheit Berlin
Alt-Friedrichsfelde 60, 10315 Berlin

Contact person

Herr Reich

Fon +49 (0) 30 902 545 - 572

Fax +49 (0) 30 902 545 - 315

FIRE BRIGADE

Direktion Süd
Vorbeugender Brandschutz
- Veranstaltungsabnahmen -
Kirchhofstraße 20, 12051 Berlin

Contact person

Herr Wehner

Fon +49 (0) 30 387 502 - 37

Fax +49 (0) 30 387 502 - 97

Feuerwache Kreuzberg
Wiener Straße 64, 10999 Berlin

Fon +49 (0) 30 617 871 - 11

POLICE

Direktion 5 – Abschnitt 53
Friedrichstraße 219, 10969 Berlin
Fon +49 (0)30 466 45 53 - 700 / 701 (Wache)
Fax +49 (0)30 466 45 53 - 799
Internet www.polizei.berlin.de

ROAD TREFFIC AUTHORITY

Frankfurter Allee 35 - 37
10245 Berlin

Contact person

Herr Hoffleit

Fon +49 (0)30 902 98 - 8078

Fax +49 (0)30 902 98 - 8019

MEDICAL SERVICES

HOSPITALS

Krankenhaus am Urban
Krankenhausbetrieb von Berlin-Kreuzberg
Dieffenbachstr. 1, 10967 Berlin
Fon +49 (0) 30 130 21 - 0 1,7 km

Charité Universitätsklinikum
Schumannstraße 20 - 21, 10117 Berlin
Fon +49 (0) 30 450 - 50 3,4 km

INFRASTRUCTURE

AIRPORTS

- Berliner Flughafen GmbH
Flughafen Berlin-Schönefeld, 12521 Berlin
Fax +49 (0) 180 5000186 17,0 km

Directions Schönefeld Airport – Tempodrom:
From Schönefeld Airport continue straight on from the B179/Waltersdorfer Chaussee, to B179/Neuköllner Straße, Rudower Straße, Buschkrugallee, Karl-Marx-Straße, Hasenheide, Gneisenaustraße.
Turn right onto Mehringdamm, left onto Hallesches Ufer. Second turning on the right into Möckernstraße.

STATIONS

- **Berlin Hauptbahnhof**
Invalidenstraße 53, 10557 Berlin 3,9 km

Directions Hauptbahnhof – Tempodrom:
From Invalidenstraße turn left into the Tiergartentunnel. Turn left onto Schöneberger Ufer. Continue along Tempelhofer Ufer. Turn left into Möckernstraße.

- **Bahnhof Berlin-Ostbahnhof**
Am Ostbahnhof, 10243 Berlin 5,0 km

Directions Ostbahnhof – Tempodrom:
From the station into Holzmarktstraße. Left across the Jannowitzbrücke onto Brückenstraße, Heinrich-Heine-Straße. at Moritzplatz 1/4 turn onto the Oranienstraße, Kochstraße, left into Wilhelmstraße, right into Anhalter Straße. Left into Stresemannstraße.
Right into Möckernstraße.

- **Bahnhof Berlin-Zoologischer Garten**
Hardenbergplatz, 10623 Berlin 4,9 km

From Hardenbergplatz turn left into Budapester Straße, Kurfürstenstraße. Left into Schillstraße. Right into Lützowufer, Schöneberger Ufer, Tempelhofer Ufer. Left into Möckernstraße.

TAXI CENTRALS

Funktaxi Berlin: 0800 02 61 02 6 oder 030 26 10 26
City Funk: 030 21 02 02
Spreefunk: 030 44 33 22
Würfelunk: 0800 22 22 2 55 oder 030 21 01 01
Rufsäule am Anhalter Bahnhof: 030 26 231 47

PARKING

- **Parkhaus Gleisdreieck**
Schöneberger Ufer 5-9,
10785 Berlin 0,5 km
- **Parkhaus Excelsior Haus**
Stresemannstr. 68-76
10963 Berlin 0,3 km

HOTELS

- **Wyndham Grand Berlin Potsdamer Platz Hotel******
Hallesche Straße 10-14, 10963 Berlin
Fon 030 80 10 66 0, Fax 030 80 10 66 66 0
www.wyndhamgrandberlin.com
- **Mövenpick Hotel ******
Schönebergerstraße 3, 10963 Berlin
Fon 030 23 00 60, Fax 030 30 23 00 61 99
www.moevenpick-berlin.com
- **Scandic Berlin **** am Potsdamer Platz**
Gabrielle-Tergit-Promenade 19, 10963 Berlin
Fon 030 700 779 0, Fax 030 700 779 2211
www.scandichotels.com/berlin
- **Relexa Hotel Stuttgarter Hof ******
Anhalterstraße 8-9, 10963 Berlin
Fon 030 26 48 30, Fax 030 26 48 39 00
www.relexa-hotels.de
- **NH Hotel Potsdamer Platz *****
Stresemannstraße 47, 10963 Berlin
Fon 030 20 62 07 33, Fax 030 22 50 71 90 0
www.nh-hotels.com
- **Suitehotel *** am Potsdamer Platz**
Anhalter Straße 2, 10963 Berlin
Fon 030 20 05 60, Fax 030 20 05 62 00
www.suite-hotel.com
- **Express by Holiday Inn *****
Stresemannstraße 49, 10963 Berlin
Fon 030 26 48 30, Fax 030 26 48 39 00
www.hiexpress.de
- **Ibis Hotel ** am Potsdamer Platz**
Anhalter Straße 4, 10963 Berlin
Fon 030 26 10 50, Fax 030 26 10 52 22
www.ibishotel.de
- **Hotel am Anhalter Bahnhof ****
Stresemannstraße 36, 10963 Berlin
Fon 030 25 80 07 0, Fax 030 25 14 89 7
www.hotel-anhalter-bahnhof.de
- **Etap Hotel * am Potsdamer Platz**
Anhalter Straße 6, 10963 Berlin
Fon 030 25 76 77 0
www.etaphotel.com

HOW TO FIND TEMPODROM

ADDRESS

Tempodrom, Möckernstraße 10, 10963 Berlin
Tel +49 (0) 30 74 73 7 - 0
Fax +49 (0) 30-74 73 7 - 210

CAR & LORRY

From the city Autobahn A100 towards Dresden, to exit B96-Tempelhofer Damm. Turn left onto the Tempelhofer Damm. Straight on to Mehringdamm. Turn left onto Hallesches Ufer. Second turning on the right onto Möckernstraße. Tempodrom is located approx. 200 m on the left-hand side. Access road to the stage is directly on Möckernstraße.

Public transport

- S-Bahn: line S1/ S2/ S25/ S26 to station Anhalter Bahnhof
- U-Bahn: line U1/ U7 to Möckernbrücke station, line U2 to Mendelssohn-Bartholdy Park station
- Bus:

Bus route 129 to Anhalter Bahnhof
Bus route 248 to Möckernstraße
Bus route M41 to Anhalter Bahnhof

PARKING

Only limited public parking is available in the direct vicinity of the Tempodrom. In Parkhaus Gleisdreieck multi-storey carpark (Schöneberger Ufer), only 8 minutes' walk away are over 2,000 car parking spaces available for a fee.

- 1 Tempodrom
- 2 Tiergarten
- 3 Siegestsäule
- 4 Brandenburger Tor
- 5 Potsdamer Platz
- 6 Towards Airfield
Schönefeld
- 7 Autobahn access
100,103, 102
- 8 multi-storey car park
Gleisdreieck
- 9 Car park
Excelsiorhaus
- 10 Car park
Martin-Gropius-Bau



CONTACT PERSONS

OPERATOR

Tempodrom
Betriebsgesellschaft mbH & Co. KG
Möckernstraße 10
10963 Berlin

Fon +49 (0) 30 74 73 7 - 0
Fax +49 (0) 30 74 73 7 - 210

E-mail info@tempodrom.de
Internet www.tempodrom.de

VENUE MANAGER

Karolin Gramsch
Fon +49 (0) 30 74 73 7 - 213
Fax +49 (0) 30 74 73 7 - 210
E-Mail karolin.gramsch@tempodrom.de

COMMUNICATION, PR & MARKETING

Jessica Paul, Fränze Drescher
Fon +49 (0) 30 74 73 7 - 214
Fax +49 (0) 30 74 73 7 - 210
E-Mail jessica.paul@tempodrom.de

ACCOUNTANCY

Stephanie Warnecke
Fon +49 (0) 30 74 73 7 - 228
Fax +49 (0) 30 74 73 7 - 210
E-Mail stephanie.warnecke@tempodrom.de

SALES MANAGER

PUBLIC EVENTS

Moritz Vasek
Fon +49 (0) 30 74 73 7 - 215
Fax +49 (0) 30 74 73 7 - 210
E-Mail moritz.vasek@tempodrom.de

SALES MANAGER

CORPORATE EVENTS

Marko Schilp
Fon +49 (0) 30 74 73 7 - 218
Fax +49 (0) 30 74 73 7 - 210
E-Mail marko.schilp@tempodrom.de

TECHNICAL DIRECTOR

Steve Thiede
Fon +49 (0) 30 74 73 7 - 249
Fax +49 (0) 30 74 73 7 - 250
E-mail steve.thiede@tempodrom.de

TECHNICAL PROJECT MANAGER

Mike Groß
Fon +49 (0) 30 74 73 7 - 248
Fax +49 (0) 30 74 73 7 - 250
E-mail produktion@tempodrom.de

FOOD AND BEVERAGE

Mario Treugut
Fon +49 (0) 30 74 73 7 - 216
Fax +49 (0) 30 74 73 7 - 210
E-Mail mario.treugut@tempodrom.de

NORTH VIEW

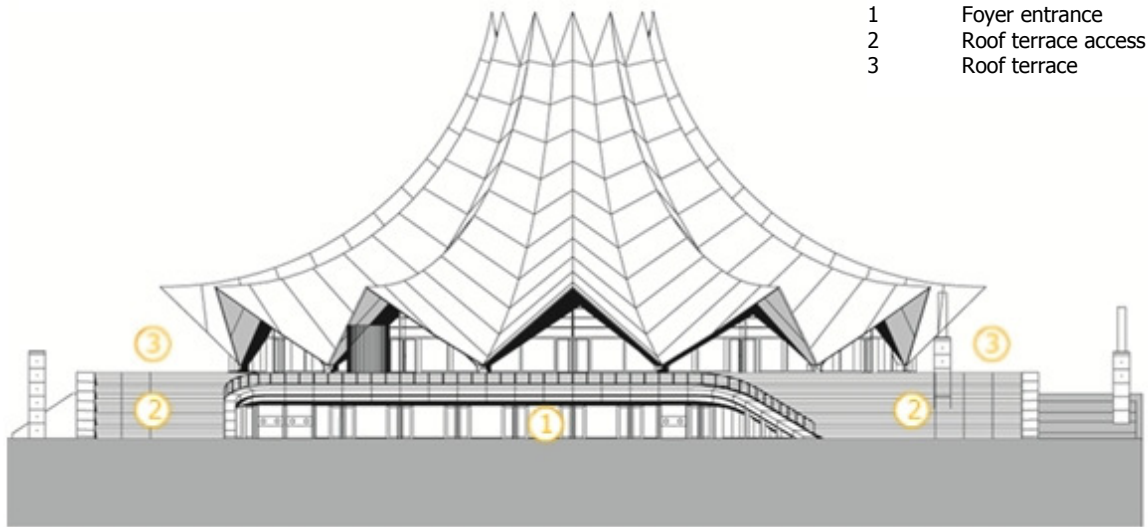

- 1 Foyer entrance
- 2 Roof terrace access
- 3 Roof terrace

SOUTH VIEW

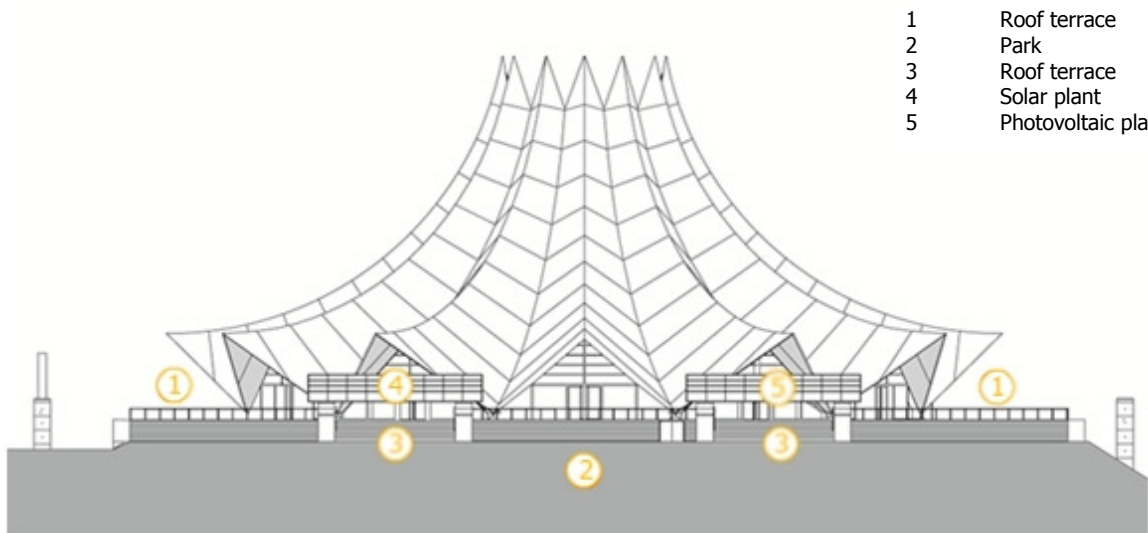

- 1 Roof terrace
- 2 Park
- 3 Roof terrace
- 4 Solar plant
- 5 Photovoltaic plant

EAST VIEW

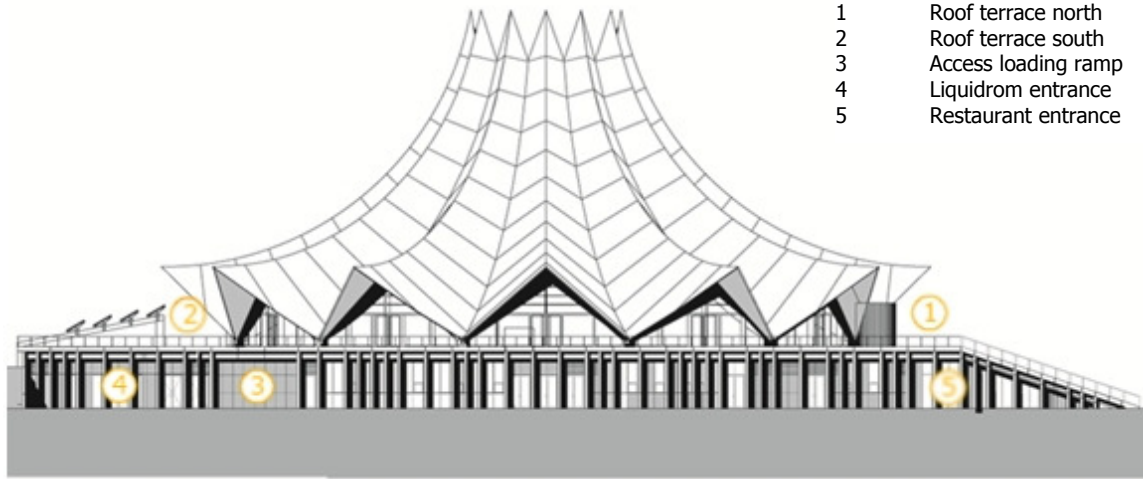

- 1 Roof terrace north
- 2 Roof terrace south
- 3 Access loading ramp
- 4 Liquidrom entrance
- 5 Restaurant entrance

WEST VIEW

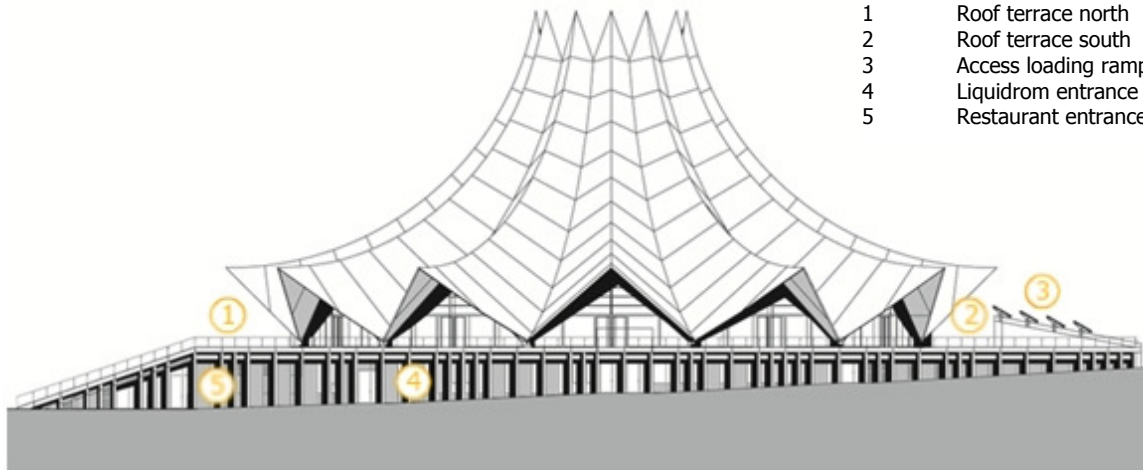

- 1 Roof terrace north
- 2 Roof terrace south
- 3 Access loading ramp
- 4 Liquidrom entrance
- 5 Restaurant entrance

SECTIONAL VIEW NORTH - SOUTH

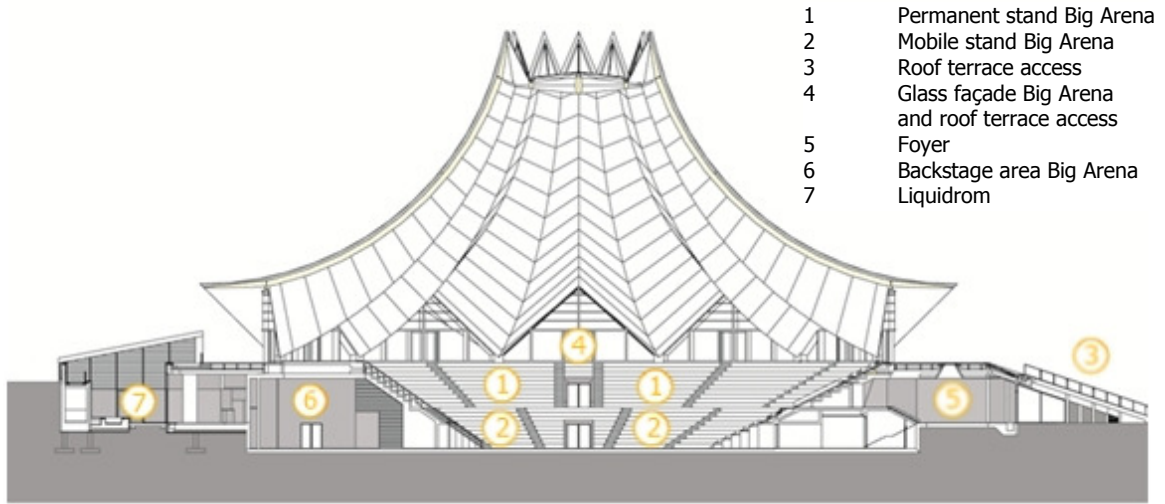

SECTIONAL VIEW EAST - WEST

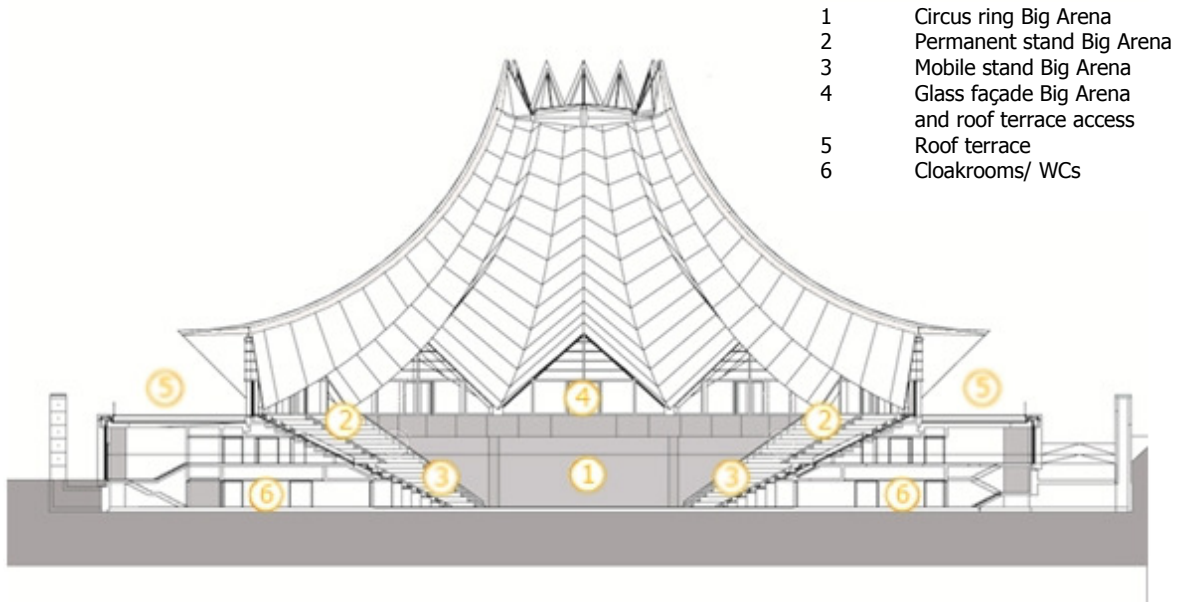

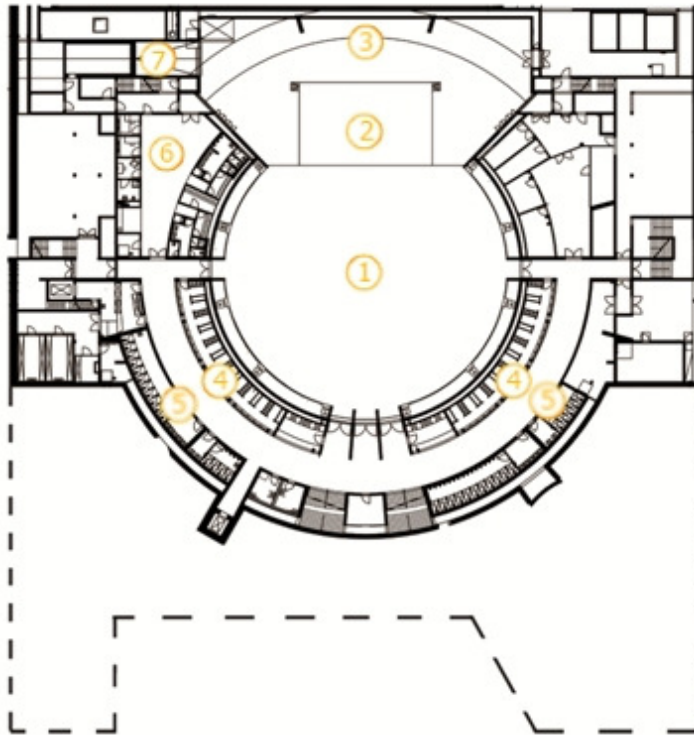

LAYOUT BASEMENT

- 1 Circus Ring
- 2 Scene area
- 3 Scene rear area
- 4 Cloakrooms
- 5 Public Toilets
- 6 Backstage East
- 7 Big Arena loading ramp

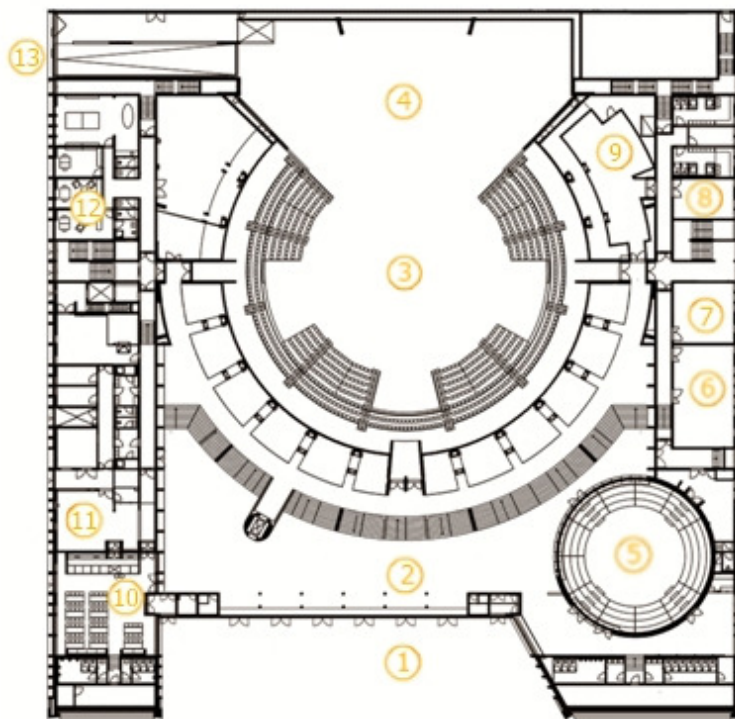

LAYOUT GROUND FLOOR

- 1 Entrance
- 2 Foyer
- 3 Big Arena
- 4 Scene Arena
- 5 Small Arena
- 6 Catering
- 7 Dressing Room 2
- 8 Dressing Room 1
- 9 Lounge
- 10 Restaurant
- 11 Kitchen
- 12 Administration
- 13 Big Arena loading ramp access

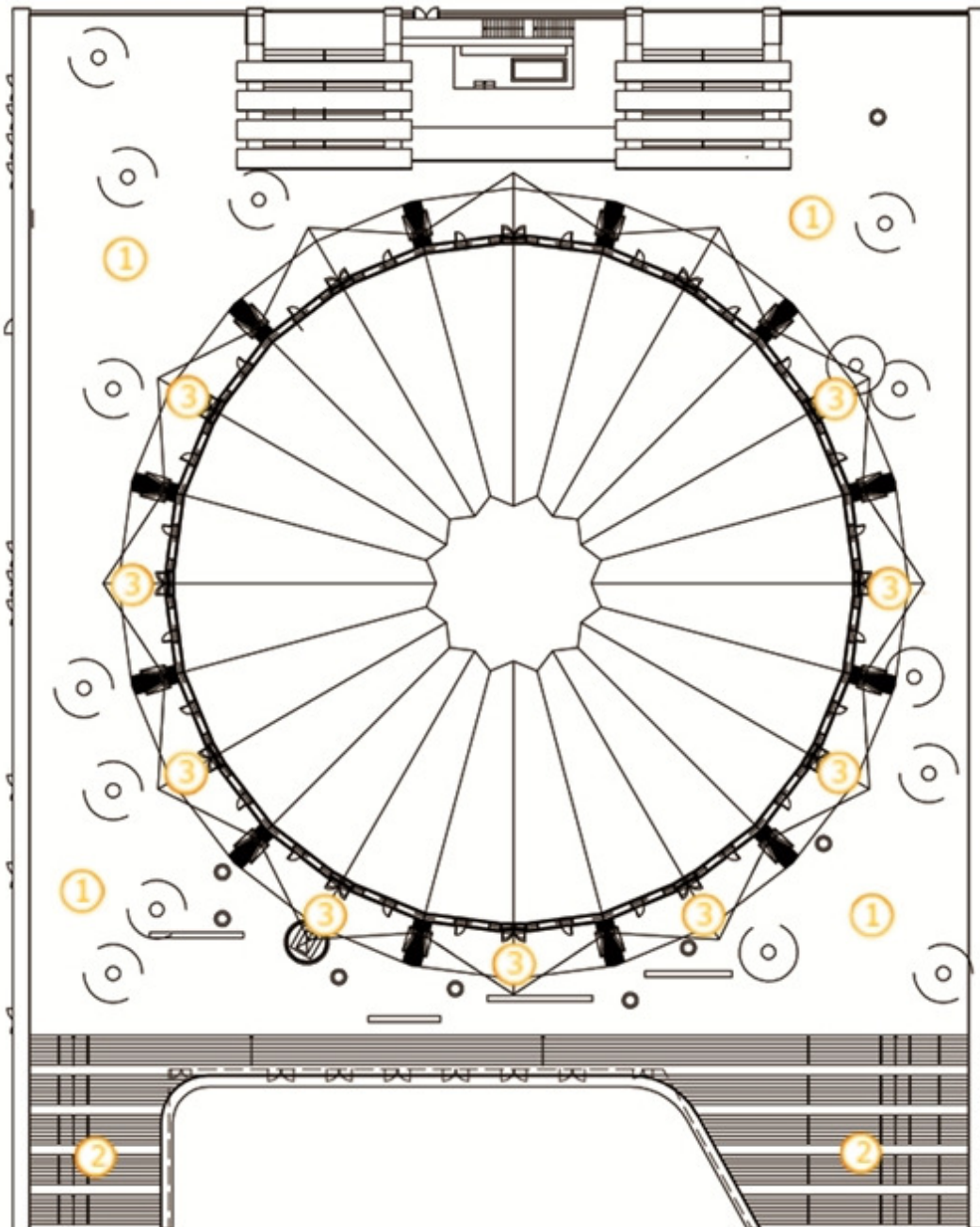

LAYOUT ROOF TERRACE

- 1 Roof terrace
- 2 Outdoor stairs and roof terrace entrance
- 3 Access from Big Arena to roof terrace

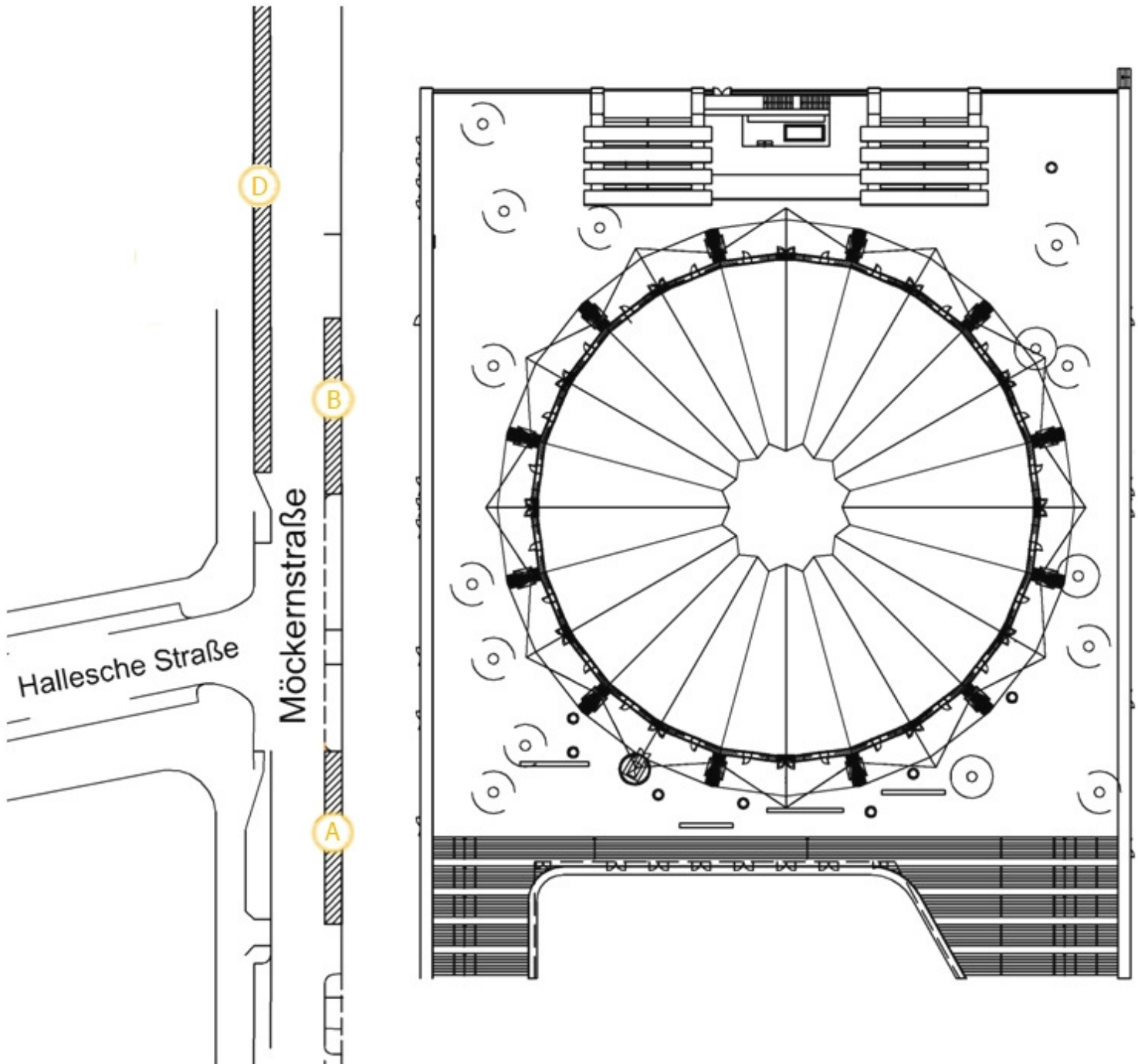

BLOCKABLE PARKING ZONES

- A Parking zone A ca. 20 m
- B Parking zone B ca. 20 m
- D Parking zone D ca. 70 m

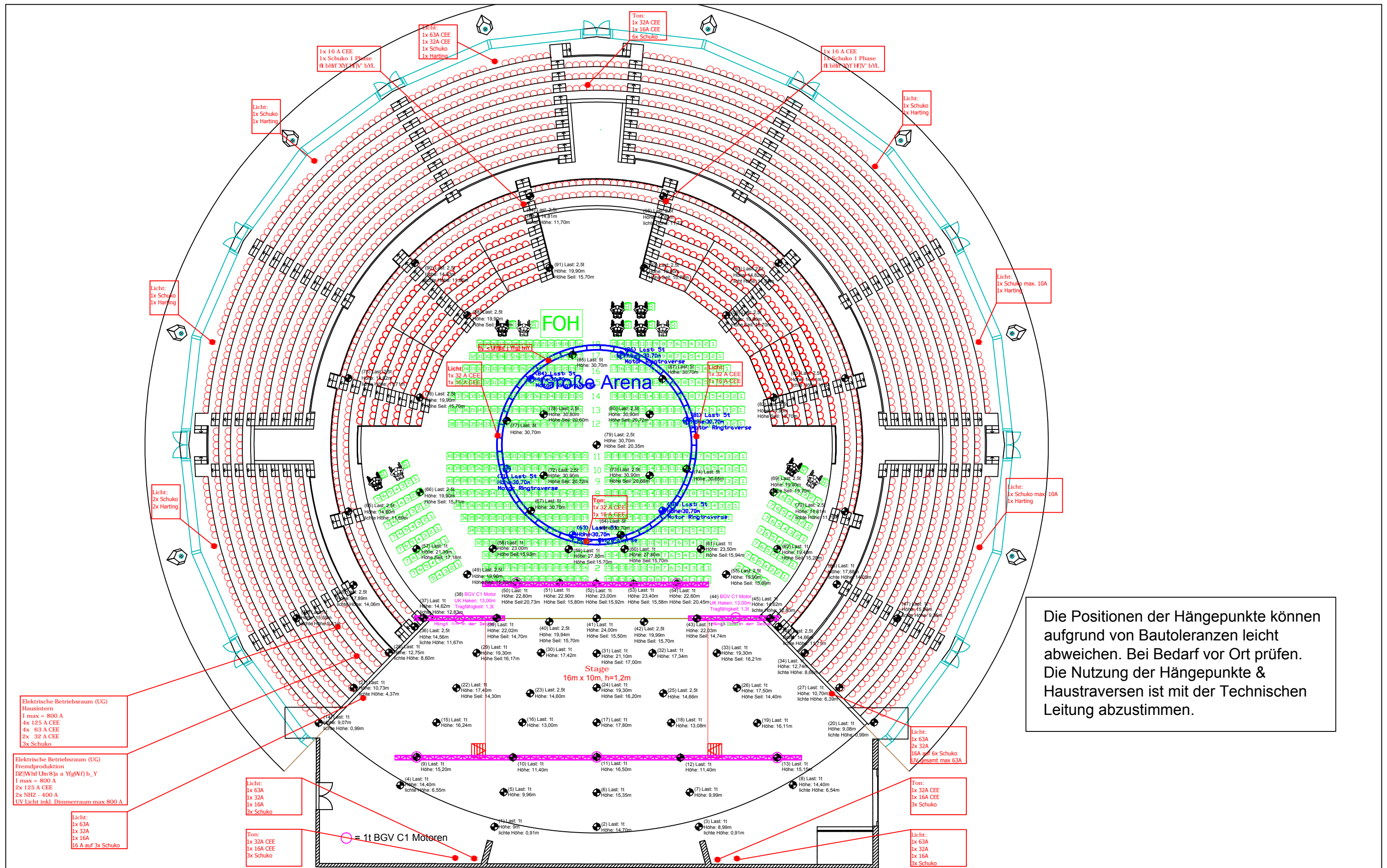

Die Positionen der Hängepunkte können aufgrund von Bautoleranzen leicht abweichen. Bei Bedarf vor Ort prüfen. Die Nutzung der Hängepunkte & Haustraversen ist mit der Technischen Leitung abzustimmen.

Elektrische Betriebsraum (UG)
Hausintern
I max = 800 A
4x 125 A CEE
4x 63 A CEE
2x 32 A CEE
3x Schuko

Elektrische Betriebsraum (UG)
Fremdproduktion
DZ/WH/Ün/SJa a Yfg/Wf) b_Y
I max = 800 A
2x 125 A CEE
2x NH2 - 400 A
UV Licht inkl. Dimmerraum max 800 A

Licht:
1x 63A
1x 32A
1x 16A
16 A auf 3x Schuko

Licht:
1x 63A
1x 32A
1x 16A
3x Schuko

Ton:
1x 32A CEE
1x 16A CEE
3x Schuko

Licht:
1x 63A
2x 32A
16A auf 6x Schuko
UV Gesamt max 63A

Ton:
1x 32A CEE
1x 16A CEE
3x Schuko

Licht:
1x 63A
1x 32A
1x 16A
3x Schuko

<p>Maßstab: 1:200 DIN A3</p> <p>ÄNDERUNGEN VORBEHALTEN. ALLE MAßE SIND AM BAU ZU PRÜFEN. UNTER VORBEHALT BIS ZUR GENEHMIGUNG DURCH DIE ZUSTÄNDIGEN BEHÖRDEN.</p>	<h1>Hängepunkte</h1>	<p>Technische Leitung, Tempodrom Betriebsgesellschaft mbH & Co. KG, Möckernstrasse 10, 10963 Berlin, Fon +49 (0)30 74 73 7 -248, Fax -250</p>	
<p>Bearb von: P.Flagmeier</p>	<p>Stand: 12.12.2014</p>	<p>Kapazität: -</p>	<p>Version: 1.0</p>

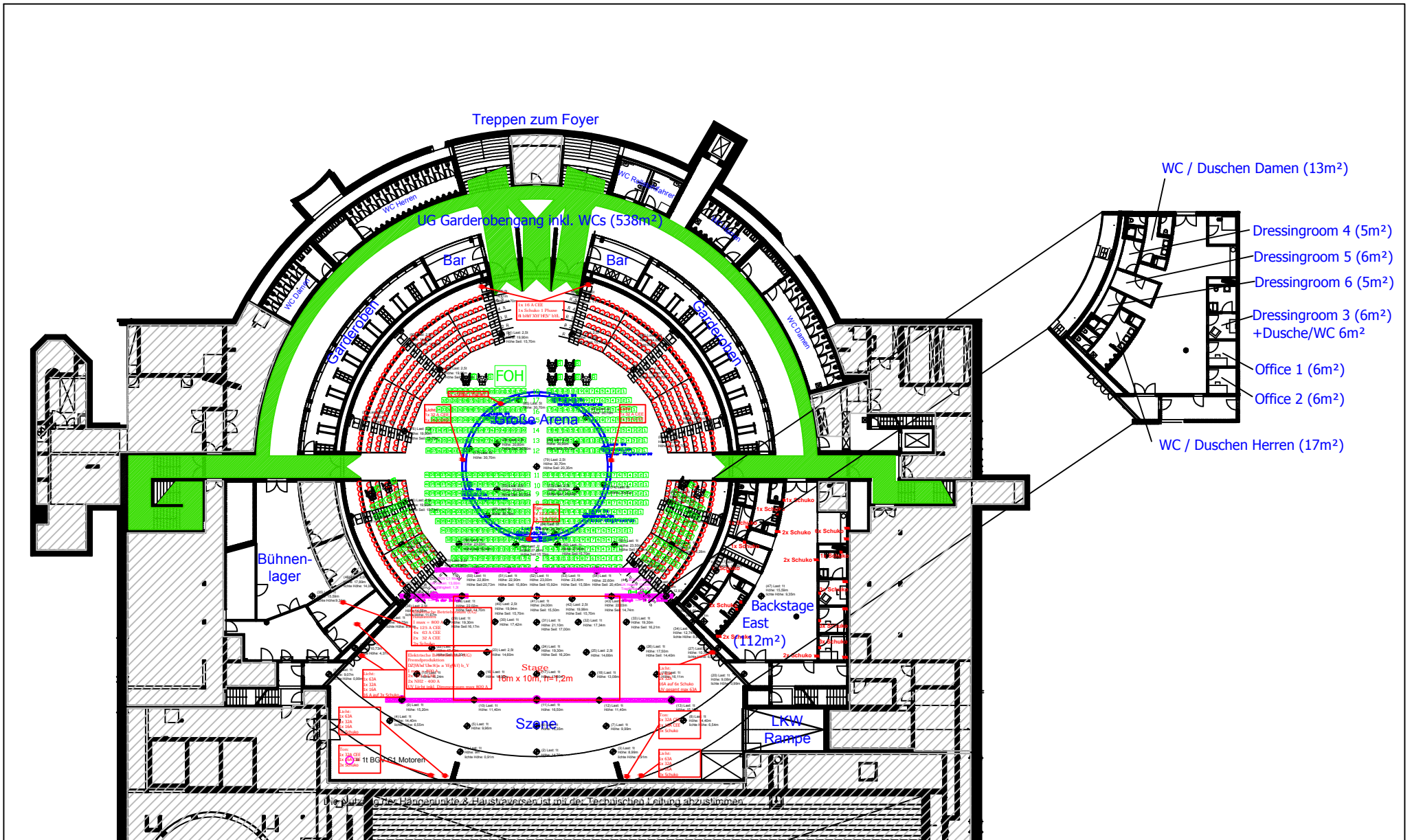

Maßstab:
1:500
DIN A4

Untergeschoss



Technische Leitung, Tempodrom Betriebsgesellschaft mbH & Co. KG,
Möckerstrasse 10, 10963 Berlin, Fon +49 (0)30 74737 - 248, Fax -250

Änderungen vorbehalten.
Alle Maße sind am Bau zu prüfen.
Unter Vorbehalt bis zur Genehmigung durch die zuständigen Behörden.

Bearb von: P. Flagmeier	Stand: 10.12.2014	Kapazität: je nach Bestuhlung	Version: 1.0
----------------------------	----------------------	----------------------------------	-----------------

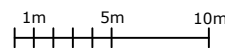
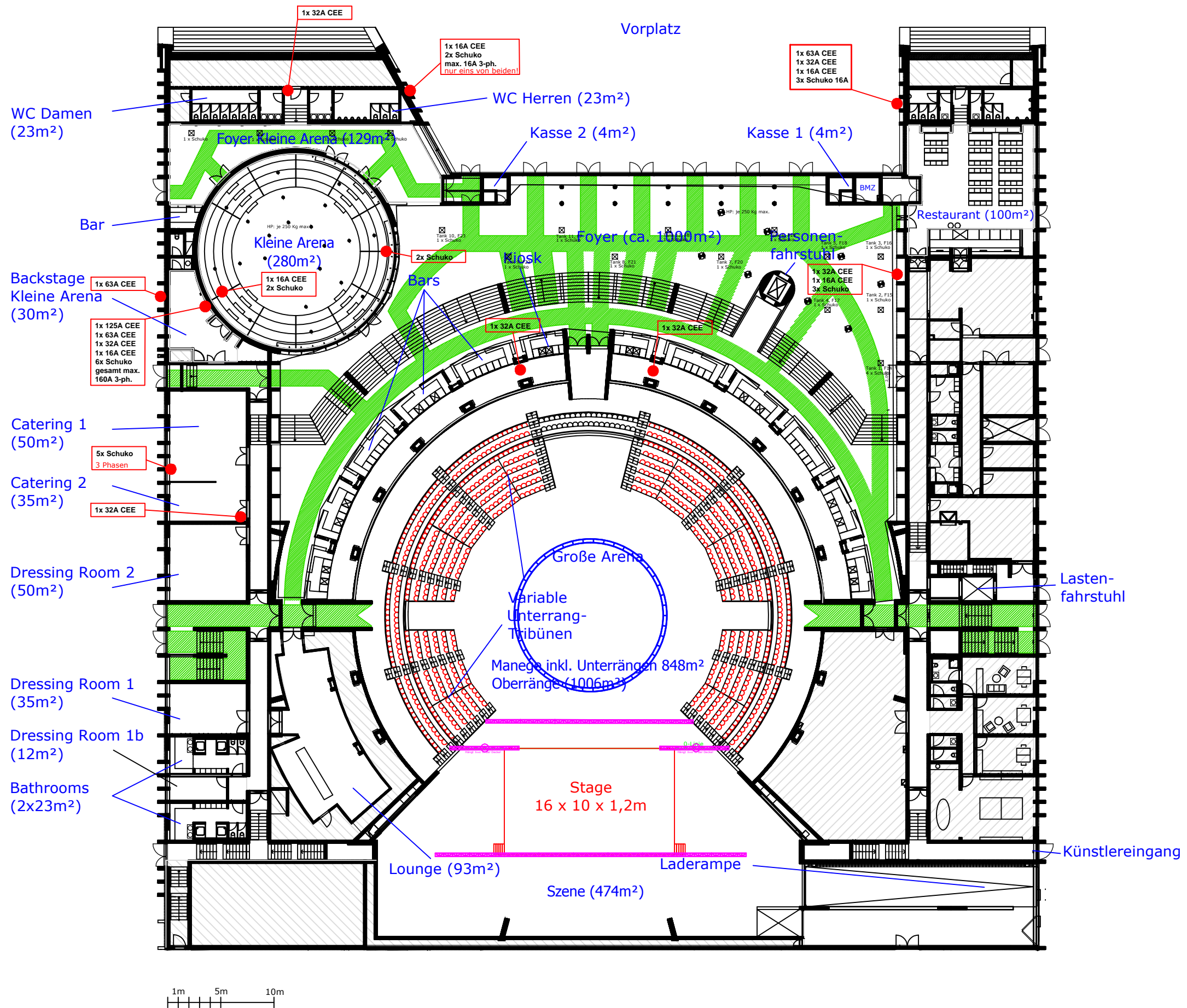

Maßstab: K.A. DIN A3	<h1>Erdgeschoss</h1>					
<small>ÄNDERUNGEN VORBEHALTEN. ALLE MAßE SIND AM BAU ZU PRÜFEN. UNTER VORBEHALT BIS ZUR GENEHMIGUNG DURCH DIE ZUSTÄNDIGEN BEHÖRDEN.</small>	<small>Technische Leitung, Tempodrom Betriebsgesellschaft mbH & Co. KG, Möckerstrasse 10, 10963 Berlin, Fon +49 (0)30 74 73 7 -248, Fax -250</small>		Bearb von: P.Flagmeier	Stand: 11.12.2014	Kapazität: je nach Bestuhlung	Version: 1.0

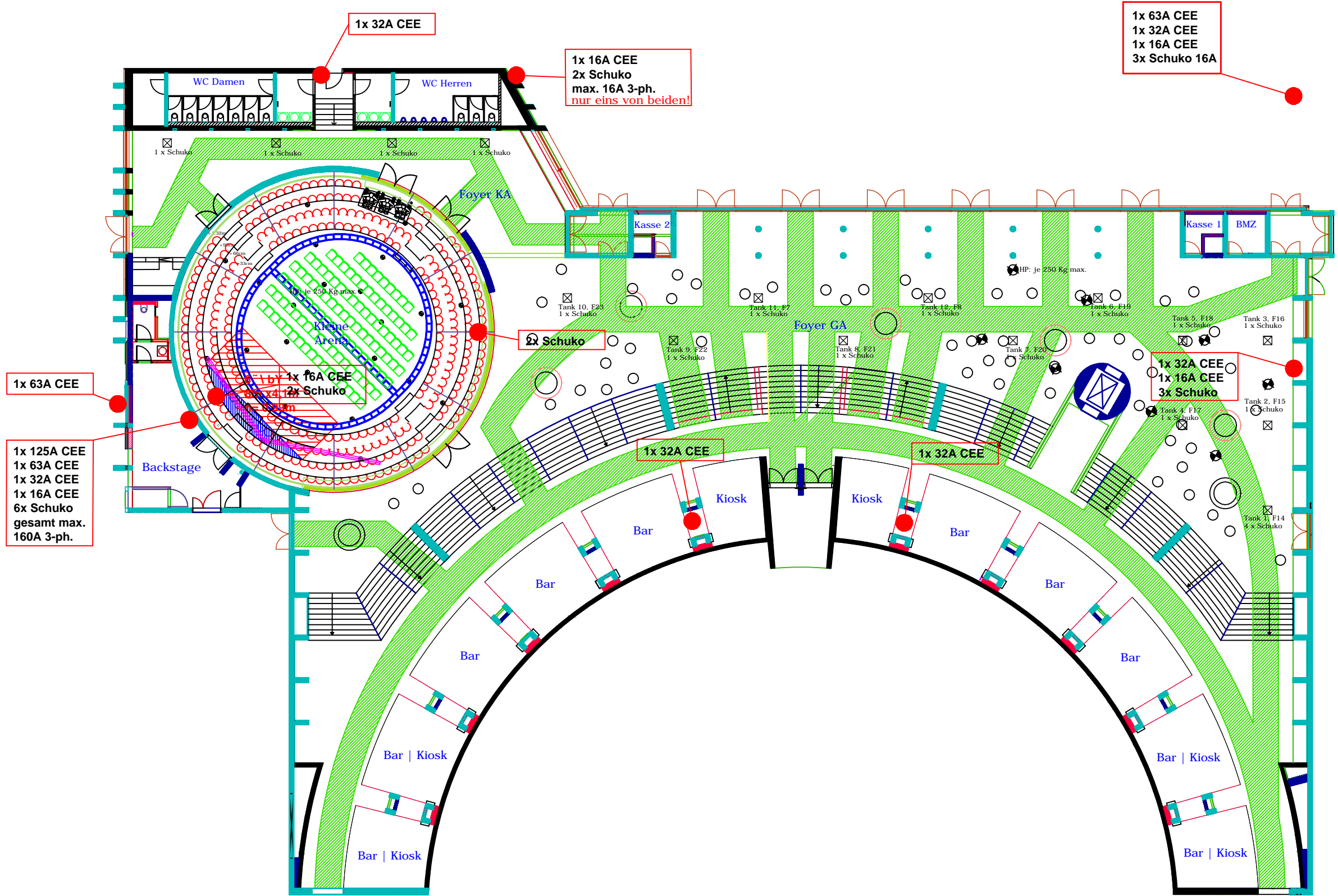

Maßstab:
1:200
DIN A3

ÄNDERUNGEN VORBEHALTEN.
ALLE MAßE SIND AM BAU ZU PRÜFEN.
UNTER VORBEHALT BIS ZUR GENEHMIGUNG
DURCH DIE ZUSTÄNDIGEN BEHÖRDEN.

Kleine Arena & Foyer



Technische Leitung, Tempodrom Betriebsgesellschaft mbH & Co. KG,
Möckernstrasse 10, 10963 Berlin, Fon +49 (0)30 74 73 7 -248, Fax -250

Bearb von: P.Flagmeier	Stand: 12.12.2014	Kapazität: je nach Bestuhlung	Version: 1.0
---------------------------	----------------------	----------------------------------	-----------------